

- Hardened and ground shaft for linear guidance with threaded holes

- Material:

Hardened ground steel Ck55

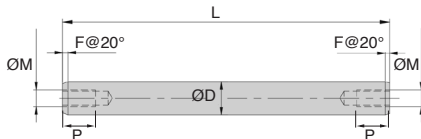

Tapped holes

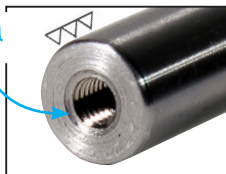

### DISCOUNTS

Qty	1+	2+	4+	8+
Disc.	List	-15%	-20%	On request

Part number	ØD (h6)	Length L (mm)	F	ØM	P	Weight (kg)	Stock*	Price each
Z12-100A-M5/M5	12	100	1,8	M5	10	0,089	-	33,09 €
Z12-200A-M5/M5	12	200	1,8	M5	10	0,178	-	38,28 €
Z12-300A-M5/M5	12	300	1,8	M5	10	0,267	-	43,47 €
Z12-400A-M5/M5	12	400	1,8	M5	10	0,356	-	48,63 €
Z12-500A-M5/M5	12	500	1,8	M5	10	0,445	-	53,82 €
Z12-600A-M5/M5	12	600	1,8	M5	10	0,534	-	58,98 €
Z16-100A-M6/M6	16	100	2,0	M6	12	0,157	-	39,48 €
Z16-200A-M6/M6	16	200	2,0	M6	12	0,314	-	45,96 €
Z16-300A-M6/M6	16	300	2,0	M6	12	0,471	-	52,44 €
Z16-400A-M6/M6	16	400	2,0	M6	12	0,628	-	58,92 €
Z16-500A-M6/M6	16	500	2,0	M6	12	0,785	-	65,43 €
Z16-600A-M6/M6	16	600	2,0	M6	12	0,942	-	71,91 €
Z16-700A-M6/M6	16	700	2,0	M6	12	1,099	-	78,39 €
Z16-800A-M6/M6	16	800	2,0	M6	12	1,256	-	84,87 €
Z20-100A-M8/M8	20	100	2,2	M8	16	0,245	-	41,64 €
Z20-200A-M8/M8	20	200	2,2	M8	16	0,490	-	49,08 €
Z20-300A-M8/M8	20	300	2,2	M8	16	0,735	-	56,49 €
Z20-400A-M8/M8	20	400	2,2	M8	16	0,980	-	63,93 €
Z20-500A-M8/M8	20	500	2,2	M8	16	1,225	-	71,34 €
Z20-600A-M8/M8	20	600	2,2	M8	16	1,470	-	78,75 €
Z20-700A-M8/M8	20	700	2,2	M8	16	1,715	-	86,19 €
Z20-800A-M8/M8	20	800	2,2	M8	16	1,960	-	93,60 €
Z20-900A-M8/M8	20	900	2,2	M8	16	2,205	-	101,04 €
Z20-1000A-M8/M8	20	1000	2,2	M8	16	2,450	-	108,48 €
Z25-100A-M10/M10	25	100	2,5	M10	20	0,383	-	51,42 €
Z25-200A-M10/M10	25	200	2,5	M10	20	0,766	-	60,27 €
Z25-300A-M10/M10	25	300	2,5	M10	20	1,149	-	69,15 €
Z25-400A-M10/M10	25	400	2,5	M10	20	1,532	-	78,03 €
Z25-500A-M10/M10	25	500	2,5	M10	20	1,915	-	86,91 €
Z25-600A-M10/M10	25	600	2,5	M10	20	2,298	-	95,76 €
Z25-700A-M10/M10	25	700	2,5	M10	20	2,681	-	104,64 €
Z25-800A-M10/M10	25	800	2,5	M10	20	3,064	-	113,49 €
Z25-900A-M10/M10	25	900	2,5	M10	20	3,447	-	122,37 €
Z25-1000A-M10/M10	25	1000	2,5	M10	20	3,830	-	131,25 €

\*Dans la limite du disponible - Dimensions en mm

## Altri prodotti...



BAC110

Contenitore a becco,  
Aggancio orientabile



RJUM05

Supporto per boccola  
Drylin R®, Chiuso -  
Corto



PCS50SS

Pignone a catena -  
Inox, 12.7mm (DIN  
08B-1)



BLHB60

Rinvio angolare ad  
albero cavo, fino a 70  
Nm



CHAEss

Cerniera estetica, Inox



DOMI50

Accessori di  
collegamento, Piatto  
girevole

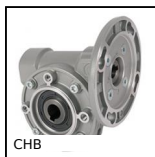

CHB

Riduttore a ruota e  
vite senza fine, fino a  
41 Nm



VTLB

Three-lobed knob,  
Thermoplastic / Brass  
or stainless steel  
insert



CLR

Staffa di montaggio  
per molla a gas,  
Staffa di montaggio



PRF\_PL\_4590

Elementi di giunzione,  
Piastra di giunzione -  
45x90 mm



PRF\_T

Squadra di giunzione,  
Angolare di rinforzo

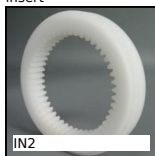

IN2

Ingranaggio interno,  
Plastica lavorata  
(delrin)

## Prodotti correlati



ZA

Albero per guida  
lineare, Acciaio  
temprato



BPQ

Quadro linear ball  
bearing unit, Included  
4 linear ball bearings



ZB

Albero per guida  
lineare, Inox temprato

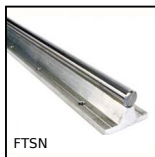

FTSN

Albero supportato per  
guida lineare, Albero  
acciaio / supporto  
allu...