

## TTBss TBss

For axial loads

- Bearing for axial loads
- With internal groove
- Not suitable for radial load
- Oil lubrication
- Outdoor durability
- Chemical solvent resistant
- Material :  
Stainless steel

stainless steel



### Info

- \*\*Load ratings are calculated based on steel version. The rates are approximately 20% lower for stainless steel

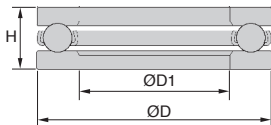

### DISCOUNTS

Qty	1+	4+	10+
Disc.	List	-15%	On request

Part Number	ØD1	ØD	H	Load capacity**		Max speed (rpm)		Weight (g)	Stock*	Price each 1 to 3
				Dynamic C	Static Co	Lubrication Grease	Oil			
TTB3/SS	3	8	3,5	-	-	-	15000	↻		
TTB4/SS	4	10	4	-	-	-	15000	↻		
TTB5/SS	5	12	4	-	-	-	13000	↻		
TTB6/SS	6	14	5	-	-	-	10000	↻		
TTB7/SS	7	17	6	-	-	-	10000	↻		
TTB8/SS	8	19	7	-	-	-	8000	↻		

\*Depending on availability - Dimensions in mm

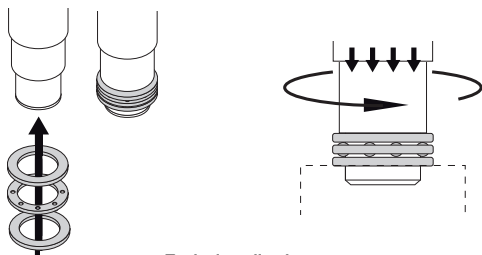

Typical application

## DISCOUNTS

Qty	1+	4+	10+
Disc.	List	-15%	On request

Part Number	ØD1	ØD	H	Load capacity**		Max speed (rpm)		Weight (g)	Price each 1 to 3
				Dynamic C	Static Co	Lubrication Grease	Oil		
TB51100/SS	10	24	9	-	-	7500	9500	20	
TB51200/SS	10	26	11	-	-	6000	8000	29	
TB51101/SS	12	26	9	-	-	7000	9500	22	
TB51201/SS	12	28	11	-	-	6000	8000	32	
TB51102/SS	15	28	9	-	-	6300	8500	24	
TB51202/SS	15	32	12	-	-	5000	6700	43	
TB51103/SS	17	30	9	-	-	6300	8500	28	
TB51203/SS	17	35	12	-	-	5000	6700	50	
TB51104/SS	20	35	10	-	-	5600	7500	40	
TB51204/SS	20	40	14	-	-	4300	5600	82	
TB51105/SS	25	42	11	-	-	4800	6300	59	
TB51305/SS	25	47	15	-	-	3800	5000	120	
TB51106/SS	30	47	11	-	-	4500	6000	68	
TB51306/SS	30	52	16	-	-	3600	4500	150	
TB51107/SS	35	52	12	-	-	4300	5600	90	
TB51307/SS	35	62	18	-	-	3000	4000	220	
TB51108/SS	40	60	13	-	-	3800	5000	120	
TB51308/SS	40	68	19	-	-	2900	3800	270	
TB51109/SS	45	65	14	-	-	3400	4500	150	
TB51309/SS	45	73	20	-	-	2500	3500	320	
TB51110/SS	50	70	14	-	-	3300	4500	160	
TB51310/SS	50	78	22	-	-	2400	3400	390	
TB51111/SS	55	78	16	-	-	2700	3800	240	
TB51311/SS	55	90	25	-	-	1900	2800	610	
TB51112/SS	60	85	17	-	-	2600	3700	290	
TB51311/SS	55	90	25	-	-	1900	2800	610	
TB51112/SS	60	85	17	-	-	2600	3700	290	

\*Depending on availability - Dimensions in mm

## Altri prodotti...



CLB\_M

Maniglia a ripresa,  
Zamak

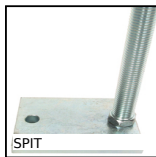

SPIT

Piede senza snodo,  
Con foro per fissaggio



DKGS

Giunto senza gioco  
Gerwah®, da 0.5 a  
3Nm



PT881

Pignone di trazione,  
Serie 881



APBC

Supporto per sensore,  
Tubo di collegamento  
per morsetto



gt64r

Chiusura a farfalla a  
molla, Tolleranze di  
montaggio ampie



NK17

Guida mini Drylin® N,  
Larghezza 17 mm



AC144

Piastrina di riscontro  
piatta per chiusura,  
22mm



SSDB

Ingranaggio conico  
inox, 2:1



MDB\_MTB

Ingranaggio conico in  
plastica stampata,  
3:1



EHD16

Riduttore coassiale,  
da 210 a 380 Nm



SUPCC

Calettatore di  
bloccaggio  
autocentrante acciaio,  
Con ghiera

**Prodotti correlati**