

Sealed flange bearing unit for Food Industry

SBFop

With 4 fixing holes

- **Sealed bearing**
- Massive, without retention surface
- Resistant to frequent washing and detergents
- Materials
 - 316 stainless steel housing
 - 440 stainless steel bearing
 - Optical and detectable blue hygienic seals
- Complies with EHEDGE hygiene directives

NEW !

open



Application

- For the highly challenging food and beverage industry

Info

- Stainless steel bearings for the food and beverage industry are completely sealed units with an open or closed cover and a rear seal.

Blue foodgrade cover seal

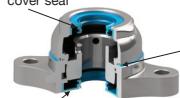

Blue foodgrade back seal



O-ring

DHRGS foodgrade hygienic seal

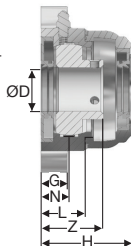
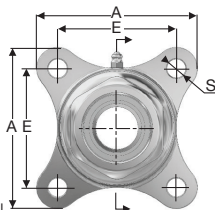

Type	SBF 204	SBF 205	SBF 206	SBF 207	SBF 208	SBF 209	SBF 210
of load (N)	15950	13000	18000	18500	19100	19350	19650

	15950	13000	18000	18500	19100	19350	19650
--	-------	-------	-------	-------	-------	-------	-------

	10250	12150	17700	18500	19250	19350	19620
--	-------	-------	-------	-------	-------	-------	-------

	3650	3350	3350	3520	3790	3850	3990
--	------	------	------	------	------	------	------

DISCOUNTS

Qty	1+	4+	8+
Disc.	List	-5%	On request

Part Number	Diameter									Price each 1 to 3
	ØD	A	E	G	H	L	N	S	Z	
SBF204/OP	20	88	64	15	51,9	24	15	12	33,0	135,74 €
SBF205/OP	25	95	70	15	52,4	25	16	12	35,5	155,14 €
SBF206/OP	30	108	83	15	58,7	29	18	12	40,0	179,38 €
SBF207/OP	35	117	92	17	62,4	31	19	14	42,5	208,46 €
SBF208/OP	40	130	102	17	70,7	32	21	16	46,0	252,10 €
SBF209/OP	45	135	105	18	69,2	33	22	16	53,7	300,58 €
SBF210/OP	50	143	111	20	72,7	38	25	16	55,0	358,75 €

Dimensions in mm

Sealed flange bearing unit for Food Industry

With 4 fixing holes

SBFCL

- Sealed bearing
- Massive, without retention surface
- Resistant to frequent washing and detergents
- Materials
 - 316 stainless steel housing
 - 440 stainless steel bearing
 - Optical and detectable blue hygienic seals
- Complies with EHEDGE hygiene directives

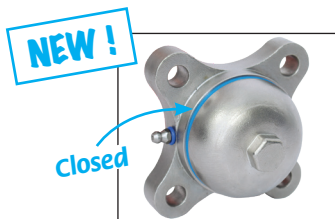

Application

- For the highly challenging food and beverage industry

Info

- Stainless steel bearings for the food and beverage industry are completely sealed units with an open or closed cover and a rear seal.

Blue foodgrade cover seal

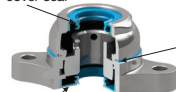

Blue foodgrade back seal



O-ring

DHRGS foodgrade hygienic seal

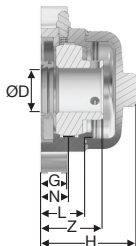
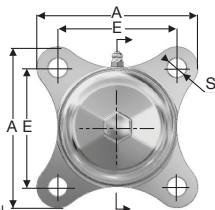

Type	SBF 204	SBF 205	SBF 206	SBF 207	SBF 208	SBF 209	SBF 210
of load (N)	204	205	206	207	208	209	210

P	15950	13000	18000	18500	19100	19350	19650
---	-------	-------	-------	-------	-------	-------	-------

P	10250	12150	17700	18500	19250	19350	19620
---	-------	-------	-------	-------	-------	-------	-------

P	3650	3350	3350	3520	3790	3850	3990
---	------	------	------	------	------	------	------

DISCOUNTS

Qty	1+	4+	8+
Disc. List	-5%	-5%	On request

Part Number	Diameter								Price each 1 to 3	
	ØD	A	E	G	H	L	N	S		Z
SBF204/CL	20	88	64	15	54,2	24	15	12	33,0	126,05 €
SBF205/CL	25	95	70	15	54,7	25	16	12	35,5	140,59 €
SBF206/CL	30	108	83	15	61,0	29	18	12	40,0	174,53 €
SBF207/CL	35	117	92	17	64,7	31	19	14	42,5	198,77 €
SBF208/CL	40	130	102	17	70,0	32	21	16	46,0	237,55 €
SBF209/CL	45	135	105	18	71,5	33	22	16	53,7	286,03 €
SBF210/CL	50	143	111	20	71,0	38	25	16	55,0	353,90 €

Dimensions in mm

Sealed flange bearing unit for Food Industry

SBFLOP

With 2 fixing holes

- **Sealed bearing**
- Massive, without retention surface
- Resistant to frequent washing and detergents
- Materials
 - 316 stainless steel housing
 - 440 stainless steel bearing
 - Optical and detectable blue hygienic seals
- Complies with EHEDGE hygiene directives

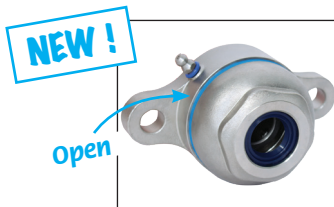

Application

- For the highly challenging food and beverage industry

Info

- Stainless steel bearings for the food and beverage industry are completely sealed units with an open or closed cover and a rear seal

Blue foodgrade cover seal

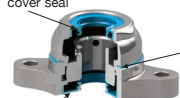

Blue foodgrade back seal



O-ring

DHRGS foodgrade hygienic seals

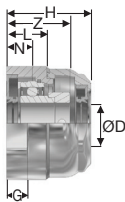
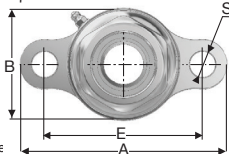

Type	SBFL 204	SBFL 205	SBFL 206	SBFL 207	SBFL 208	SBFL 209	SBFL 210
of load (N)	204	205	206	207	208	209	210

	11750	11375	16450	16900	17350	17600	17950
--	-------	-------	-------	-------	-------	-------	-------

	11000	13850	13350	13950	14050	14300	14550
--	-------	-------	-------	-------	-------	-------	-------

	8500	1100	14200	14900	15150	15350	15650
--	------	------	-------	-------	-------	-------	-------

DISCOUNTS

Qty	1+	4+	8+
Disc.	List	-5%	On request

Part Number	Diameter										Price each 1 to 3
	ØD	A	B	E	G	H	L	N	S	Z	
SBFL204/OP	20	115	65	90	11	51,9	24	15	12	33,0	130,90 €
SBFL205/OP	25	130	70	99	13	52,4	25	16	16	35,5	145,44 €
SBFL206/OP	30	148	80	117	13	58,7	29	18	16	40,0	164,83 €
SBFL207/OP	35	161	90	130	15	62,4	31	19	16	42,5	193,92 €
SBFL208/OP	40	175	100	144	15	70,7	32	21	16	46,0	237,55 €
SBFL209/OP	45	188	110	148	16	69,2	33	22	19	53,7	276,34 €
SBFL210/OP	50	197	120	157	16	72,7	38	22	19	55,0	324,82 €

Dimensions in mm

Sealed flange bearing unit for Food Industry

With 2 fixing holes

SBFLCL

- Sealed bearing
- Massive, without retention surface
- Resistant to frequent washing and detergents
- Materials
 - 316 stainless steel housing
 - 440 stainless steel bearing
 - Optical and detectable blue hygienic seals
- Complies with EHEDGE hygiene directives



Application

- For the highly challenging food and beverage industry

Info

- Stainless steel bearings for the food and beverage industry are completely sealed units with an open or closed cover and a rear seal

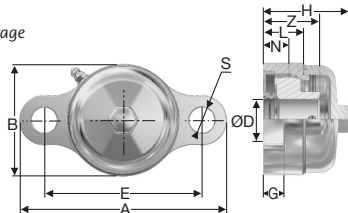
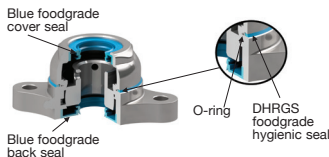

Type	SBFL 204	SBFL 205	SBFL 206	SBFL 207	SBFL 208	SBFL 209	SBFL 210
------	----------	----------	----------	----------	----------	----------	----------

	11750	11375	16450	16900	17350	17600	17950
--	-------	-------	-------	-------	-------	-------	-------

	11000	13850	13350	13950	14050	14300	14550
--	-------	-------	-------	-------	-------	-------	-------

	8500	1100	14200	14900	15150	15350	15650
--	------	------	-------	-------	-------	-------	-------

DISCOUNTS

Qty	1+	4+	8+
Disc.	List	-5%	On request

Part Number	Diameter										Price each 1 to 3
	ØD	A	B	E	G	H	L	N	S	Z	
SBFL204/CL	20	115	65	90	11	54,2	24	15	12	33,0	121,20 €
SBFL205/CL	25	130	70	99	13	54,7	25	16	16	35,5	130,90 €
SBFL206/CL	30	148	80	117	13	61,0	29	18	16	40,0	155,14 €
SBFL207/CL	35	161	90	130	15	64,7	31	19	16	42,5	184,22 €
SBFL208/CL	40	175	100	144	15	70,0	32	21	16	46,0	223,01 €
SBFL209/CL	45	188	110	148	16	71,5	33	22	19	53,7	261,79 €
SBFL210/CL	50	197	120	157	16	71,0	38	22	19	55,0	315,12 €

Dimensions in mm

Sealed flange bearing unit for Food Industry

SBFB_{OP}

With 3 offset fixing points

- Sealed bearing
- Massive, without retention surface
- Resistant to frequent washing and detergents
- Materials
 - 316 stainless steel housing
 - 440 stainless steel bearing
 - Optical and detectable blue hygienic seals
- Complies with EHEDGE hygiene directives

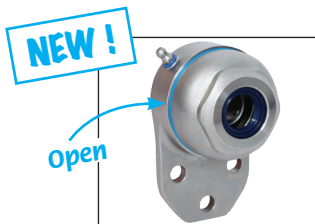

Application

- For the highly challenging food and beverage industry

Info

- Stainless steel bearings for the food and beverage industry are completely sealed units with an open or closed cover and a rear seal.

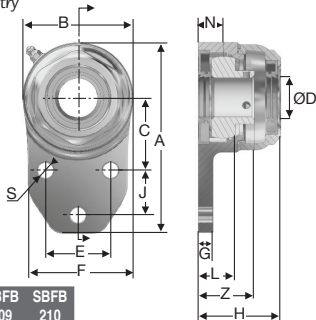
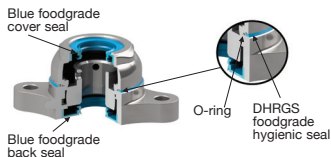

Type of load (N)	SBFB 204	SBFB 205	SBFB 206	SBFB 207	SBFB 208	SBFB 209	SBFB 210
------------------	----------	----------	----------	----------	----------	----------	----------

	-	-	-	7200	9100	12200	12900
	-	-	-	9200	11100	11800	11900
	-	-	-	2600	2800	2900	3100

DISCOUNTS

Qty	1+	4+	8+
Disc.	List	-5%	On request

Part Number	Diameter													Price each 1 to 3
	ØD	A	B	C	E	F	G	H	J	L	N	S	Z	
SBFB204/OP	20	108	65	43,3	38,1	60,3	8,0	51,9	22,0	24	15	10	33,0	140,59 €
SBFB205/OP	25	121	70	46,0	41,3	63,5	9,5	52,9	28,5	25	16	10	35,5	164,83 €
SBFB206/OP	30	137	80	52,4	47,6	70,0	9,5	58,7	31,7	29	18	10	40,0	184,22 €
SBFB207/OP	35	156	90	60,3	50,8	83,0	12,7	62,4	31,7	31	19	13	42,5	227,86 €
SBFB208/OP	40	164	100	60,3	50,0	78,0	15,9	70,7	41,3	32	21	12	46,0	271,49 €
SBFB209/OP	45	176	110	65,0	54,0	80,0	18,3	69,2	42,9	33	22	12	53,7	324,82 €
SBFB210/OP	50	190	120	74,6	70,0	102,0	12,7	72,5	41,3	38	22	13	55,0	373,30 €

Dimensions in mm

Sealed flange bearing unit for Food Industry

With 3 offset fixing points

SBFBCL

- Sealed bearing
- Massive, without retention surface
- Resistant to frequent washing and detergents
- Materials
 - B316 stainless steel housing
 - 440 stainless steel bearing
 - Optical and detectable blue hygienic seals
- Complies with EHEDGE hygiene directives

Application

- For the highly challenging food and beverage industry

Info

- Stainless steel bearings for the food and beverage industry are completely sealed units with an open or closed cover and a rear seal.

Blue foodgrade cover seal

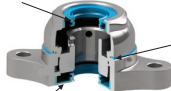

Blue foodgrade back seal

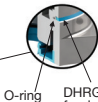

O-ring
DHRGS foodgrade hygienic seal

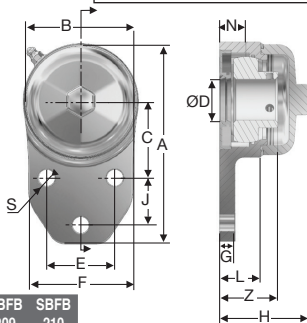

Type of load (N)	SBFB 204	SBFB 205	SBFB 206	SBFB 207	SBFB 208	SBFB 209	SBFB 210
------------------	----------	----------	----------	----------	----------	----------	----------

	-	-	-	7200	9100	12200	12900
--	---	---	---	------	------	-------	-------

	-	-	-	9200	11100	11800	11900
--	---	---	---	------	-------	-------	-------

	-	-	-	2600	2800	2900	3100
--	---	---	---	------	------	------	------

DISCOUNTS

Qty	1+	4+	8+
Disc.	List	-5%	On request

Part Number	Diameter													Price each 1 to 3
	ØD	A	B	C	E	F	G	H	J	L	N	S	Z	
SBFB204/CL	20	108	65	43,3	38,1	60,3	8,0	54,2	22,0	24	15	10	33,0	130,90 €
SBFB205/CL	25	121	70	46,0	41,3	63,5	9,5	54,7	28,5	25	16	10	35,5	150,29 €
SBFB206/CL	30	137	80	52,4	47,6	70,0	9,5	61,0	31,7	29	18	10	40,0	179,38 €
SBFB207/CL	35	156	90	60,3	50,8	83,0	12,7	64,7	31,7	31	19	13	42,5	218,16 €
SBFB208/CL	40	164	100	60,3	50,0	78,0	15,9	70,0	41,3	32	21	12	46,0	256,94 €
SBFB209/CL	45	176	110	65,0	54,0	80,0	18,3	71,5	42,9	33	22	12	53,7	310,27 €
SBFB210/CL	50	190	120	74,6	70,0	102,0	12,7	71,0	41,3	38	22	13	55,0	363,60 €

Dimensions in mm

Altri prodotti...

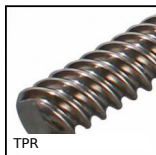

TPR

Madrevite a passo lungo, Madrevite solafino a 40mm di corsa per rot...



BABS

Perno autobloccante a sfere inox, Inox temprato



STRIP

Spazzola strip, Lunghezza 3m



SEV

Attrezzo di bloccaggio a tirante, A tirante verticale - acciaio



AK

Giunto a soffietto Gerwah®, da 36 a 800Nm



SHN

Dado esagonale - DIN934, Inox A2



YGO

Ingranaggio dritto PRESTAZIONE, Acciaio 35NCD6



BAG-MI

Anello di serraggio con intaglio e maniglia a leva, Acciaio



BLHT50

Rinvio angolare a T, da 11.50 a 30 Nm



RPCtc

Ruota girevole a foro centrale, Acciaio - Poliammide



GAL_25

Rullo per trasportatore, Senza cuscinetti a sfere



BPPL

Attrezzo di montaggio per sfera portante, Attrezzi di montaggio

Prodotti correlati



UCFL_SS

Cuscinetto a flangia ovale tutto inox, Inox



UCFL_PBT

Supporto a flangia ovale con cuscinetto, Polimero e inox



UCFL_PBT

Cuscinetto a flangia ovale Polimero inox, Polimero e inox



UCFL

Cuscinetto a flangia ovale in ghisa, Ghisa