



## RGS Couplings for servo-motors



Torque: **0.5 to 190Nm**

- No-wear elastic couplings
- No maintenance
- Low inertia and reduced size
- Easy blind assembly using standard screws
- Dampens vibration
- Electrically insulated

### Definition

- TKN Nominal torque (Nm)
- TKMAX Max. torque (Nm)

### Info

- Delivered not assembled

clamp fixing

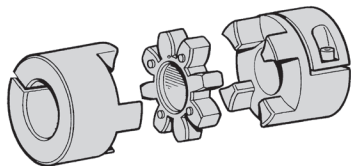
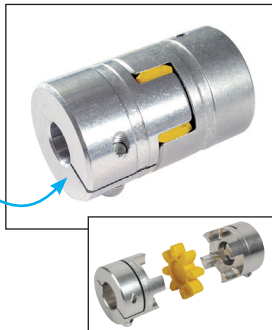

**✓ STANDARD BORE IN STOCK**

### DISCOUNTS

Qty	1+	5+	10+	25+
Disc. List	-6%	-12%	On request	

Transmissible torque (Nm) by friction for split hub

Part number	Ø3	Ø4	Ø5	Ø6	Ø7	Ø8	Ø10	Ø12	Ø14	Ø15	Ø16	Ø19	Ø20	Ø24	Ø28	Ø30	Ø32
RGS-AL-5	-	-															
RGS-AL-7		0,65	0,70	0,74	0,79												
RGS-AL-9		1,48	-	1,43	-	1,79	1,94										
RGS-AL-14			3,32	3,43	-	3,67	3,91	4,14	4,38								
RGS-AL-19							18,90	-	20,80	21,3	21,7	-	23,6				
RGS-AL-24												27,5	28	29,0	31		
RGS-AL-28														62,0	66	69	71 73

Part number	Max. speed (rpm)	Torsional stiffness		Radial stiffness (N/mm)	Torque (Nm)			Misalignment		
		static (Nm/rad)	dynamic (Nm/rad)		$T_{KSP}$	$T_{KN}$	$T_{KMAX}$	axial (mm)	radial (mm)	angular
RGS-AL-5	38 000	5,16	16	154	0,08	0,50	1,00	+0,4/-0,2	0,06	1°
RGS-AL-7	27 000	14,30	43	219	0,20	1,20	2,40	+0,6/-0,3	0,10	1°
RGS-AL-9	19 000	31,50	95	262	0,45	3,00	6,00	+0,8/-0,4	0,13	1°
RGS-AL-14	127 000	114,60	344	336	1,00	7,50	15,00	+1/-0,5	0,15	1°
RGS-AL-19	9 550	1090,00	1720	1120	2,50	12,00	24,00	+1,2/-0,5	0,10	1°
RGS-AL-24	6 950	2280,00	4010	1480	-	35,00	70,00	+1,4/-0,5	0,14	1°
RGS-AL-28	5 850	4080,00	6754	1780	-	95,00	190,00	+1,5/-0,7	0,15	1°

Dimensions in mm

## Characteristics

- Long-life
- Fixed by clamping jaw (except RGS-AL-5)
- Single-slit split hub (except RGS-AL-24 and RGS-AL-28 double slit)
- Preconstrained raised coupling
- Working temperature: -40°C to +90°C (occasional -50°C to +120°C)
- Materials:
  - Hub: aluminium
  - Ring: polyurethane elastic (92 Shore A)

## Uses

- Measuring and control instruments
- Servo-control, ball-screw systems
- Machine tools

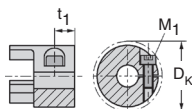
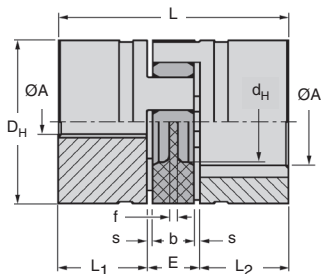

## DISCOUNTS

Qty	1+	5+	10+	25+
Disc.	List	-6%	-12%	On request

Part number	Clamping screw			Tightening torque $T_A$ (Nm)
	$M_1$	$t_1$	$\varnothing D_K$	
RGS-AL-5	M1,2	2,5	11,4	-
RGS-AL-7	M2,0	3,5	16,5	0,37
RGS-AL-9	M2,5	5,0	23,4	0,76
RGS-AL-14	M3,0	5,0	32,2	1,34
RGS-AL-19	M6,0	12,0	45,7	10,50
RGS-AL-24	M6,0	10,5	56,4	10,50
RGS-AL-28	M8,0	11,5	72,6	25,00

Part number	Standard bore									Price each 1 to 4
	$\varnothing A$ (H7)	$D_H$	$d_H$	L	$L_1;L_2$	E	b	s	f	
RGS-AL-5	Plein	10	-	15	5	5	4	0,5	4,0	40,38 €
RGS-AL-7	4, 5, 6, 7	14	-	22	7	8	6	1,0	6,0	68,24 €
RGS-AL-9	4, 6, 8, 10	20	7,2	30	10	10	8	1,0	1,5	68,71 €
RGS-AL-14	5, 6, 8, 10, 12, 14	30	10,5	35	11	13	10	1,5	2,0	76,80 €
RGS-AL-19	10, 14, 15, 16, 20	40	18,0	66	25	16	12	2,0	3,0	178,90 €
RGS-AL-24	16, 19, 20, 24, 25	55	27,0	78	30	18	14	2,0	3,0	214,29 €
RGS-AL-28	20, 24, 25, 28, 30, 32	65	30,0	90	35	20	15	2,5	4,0	279,92 €

Dimensions in mm

## Altri prodotti...



PRF\_BP

Maniglia e battuta per porta, Arresto per porta a battente

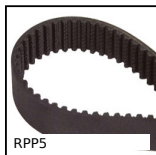

RPP5

Cinghia di trasmissione RPP, RPP5



GG1

Ingranaggio dritto rettificato, Acciaio trattato



PX

Riduttore a ruota e vite senza fine, Albero semplice in uscita per r...



RDE-B

Rondella di tenuta Hygienic Usit®, Stainless steel - EPDM blu



ACLBMC

Supporto per sensore per profili alluminio, Porta cellula



TMR

Tenditore rigido, Manuale



ACLCHARJ

Cerniera ad avvitare, Adjusts in 2 directions



MHXred

Manicotto di riduzione, Esagonale -



CHA1056-U4

Cerniera ad avvitare, Apertura 180°



PPJ

Pistoncino a molla, Con flangia di



RPP

Piastra di giunzione per cinghia RPP, RPP8

## Prodotti correlati



DKGS

Giunto senza gioco Gerwah®, da 0.5 a 3Nm



EKGS

Giunto senza gioco Gerwah®, da 0.5 a 35Nm



RTE

Rotex®, elastico, Alluminio