

- Support for RFK gearboxes
- Inward or outward facing
- Sold in pairs
- Material:
316 stainless steel

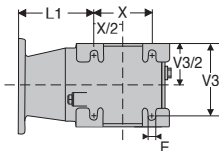

Brackets facing inwards

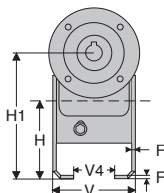
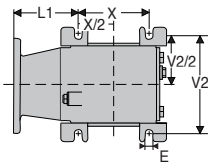
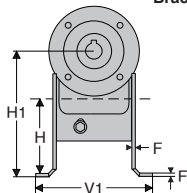

Brackets facing outwards

DISCOUNTS

Qty	1+	2+	4+
Rem.	Net	-5%	On request

Part N°	H	H1	V	V1	V2	V3	V4	X	E	F
RFK28-FP/SS	80	136,85	93	129	110	70	51	80	8,5	3
RFK38-FP/SS	90	154,50	114	157	135	85	63	100	8,5	4
RFK48-FP/SS	95	169,50	124	170	148	90	68	120	11,5	5
RFK58-FP/SS	110	198,00	144	204	178	100	74	140	13,0	5

Part N°	L1 for flange				Price each
	63B5	71B14	80B14	90B14	
RFK28-FP/SS	65,5	72,5	92,5	92,5	81,95 €
RFK38-FP/SS	67,0	74,0	94,0	94,0	104,72 €
RFK48-FP/SS	78,5	85,5	105,5	105,5	129,30 €
RFK58-FP/SS	85,0	92,0	112,0	112,0	161,17 €

All dimensions in mm

Altri prodotti...



NPTF30

Morsetto di collegamento, Fisso
Ø14 a Ø20



PVL

Volantino a lobi,
Poliammide



AT5courroie

Cinghia chiusa
posizionamento AT,
AT5 Poliuretano
armatura in acciaio



EKN

Giunto a soffietto
Gerwah®, da 0.5 a
12Nm

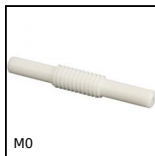

M0

Coppia ruota e vite
senza fine, Plastica
lavorata (delrin)



PRT

Corona girevole
Iglidur®, Iglidur®,
alluminio e inox



AT10-32ECO

Puleggia dentata di
posizionamento tipo
AT, Serie economica -
AT10 a...



G-ECO

Ingranaggio dritto
acciaio - serie ECO,
Acciaio C45



ACLCHARJ

Cerniera ad avvitare,
Adjusts in 2 directions

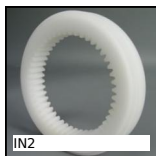

IN2

Ingranaggio interno,
Plastica lavorata
(delrin)



PRF4590

Profilato alluminio
standard, 45 x 90 mm



AT10courroie

Cinghia di
posizionamento AT,
AT10 Poliuretano
armatura in acciaio

Prodotti correlati



RFK28C

Riduttore ipoide inox,
fino a 130 Nm



RFK38B

Riduttore ipoide inox,
fino a 200 Nm



RFK38C

Riduttore ipoide inox,
fino a 200 Nm



RFK48B

Riduttore ipoide inox,
fino a 350 Nm