

- Rigging screw with 1 welded clevis and 1 manually tightened end

- Material: 316 stainless steel

Advantages

- Quick and easy fixing on the end of a cable
(For mounting method, refer to ERF/SS page)



NEW!

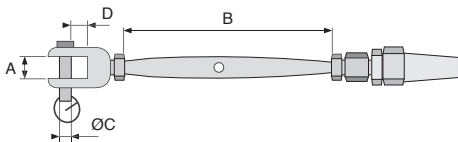

DISCOUNTS

Qty	1+	6+	20+	50+
Disc.	List	-10%	-20%	On request

Part number	For cable ØD1	A	B	ØC	D	Weight (g)	Price each 1 to 5
RDER3-5/SS	3	10	80,0	5	8	68	45,44 €
RDER3-6/SS	3	8	92,0	6	8,5	106	50,37 €
RDER4-6/SS	4	8	92,0	6	8,5	124	57,28 €
RDER4-8/SS	4	10	112,0	8	11	202	65,09 €
RDER5-8/SS	5	10	112,0	8	11	224	83,82 €
RDER5-10/SS	5	11,5	120,0	10	12	330	94,06 €
RDER6-10/SS	6	11,5	120,0	10	12	362	98,86 €
RDER6-12/SS	6	14	150,0	12	16	560	143,66 €

Dimensions in mm

Altri prodotti...



HK

Accessorio di serraggio manuale, Serraggio manuale LRX



PRF-GPA

Guide for aluminium profile, Parallel rails



SHNbr

Dado esagonale - DIN934, Ottone



CHMR30

Riduttore a ruota e vite senza fine, fino a 28 Nm



DOG316

Motoriduttore DC 12V e 24V DC, da 1.5 a 2 Nm



DB

Ingranaggio conico in acciaio, 2:1



PRF_ECL

Fissaggio, Dado quadrato con linguetta - Inox



HW_HT

Guida su semi-binari, Ruota



CMAss

Vite ad occhio, Inox



ACLEPP

Angolare, 2 fori



CM_CO

Attrezzi Hygienic Usit® and Hygienic Design®, Protective

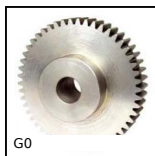

G0

Ingranaggio dritto acciaio, Acciaio 20NCD2

Prodotti correlati



ERF

Terminale rapido per cavi, Terminale filettato



RDCss

Tenditore, Inox

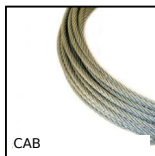

CAB

Cavo di fissaggio, Inox



ERC

Terminale rapido per cavi, A forcella