

- Profile for creating modular structures
- To be cut to length once supplied
- Material: anodised aluminium
- Covers are not sold individually, please contact us for details

Accessories

- Universal fastener PRF-FIX-UNI
- Right angle PRF19-E
- Standard fastener PRF-FIX-STD
- Screwed-in assemblies

Uses

- Light supports
- Handles
- Detector and switch supports
- Frames

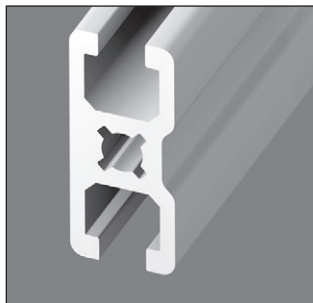

Typical application



Typical application

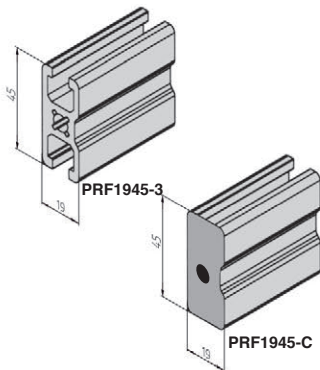

DISCOUNTS profile DISCOUNTS cover

Qty.	1+	5+	10+
Disc. List	-5%	-5%	On request

Qty.	1+	50+	100+
Disc. List	-5%	-5%	On request

Part number	lx (cm ²)	ly (cm ²)	Length (mm)	Weight (kg/m)	Stock*	Price each
Profile						
PRF1945-3	6,051	1,83	3000	1,087	✓	59,19 €
Cover						
PRF1945-C		End cover with pin			✓	0,98 €

*Depending on availability - Dimensions in mm

Altri prodotti...



GG3
Ingranaggio dritto
rettificato, Acciaio
trattato

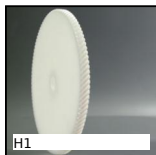

H1
Ingranaggio elicoidale
ad assi incrociati a
90°, Plastica lavorata



EFSM
Cuscinetto a flangia
quadrata Igubal®,
Polimero



ZG0
Ingranaggio dritto in
plastica, Plastica
lavorata (delrin)



T25-BAR
Barra dentata, T2.5



SSDB
Ingranaggio conico
inox, 2:1



PLM-C
Magnete piatto di
fermo, Magnete di
fermo piatto

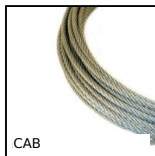

CAB
Cavo di fissaggio, Inox



AC156-157
Riscontro per chiusura
a leva rigida ad
anello, 25.5mm



CHM50
Riduttore a ruota e
vite senza fine, fino a
107 Nm



PDM_PDV
Detectable plastic
palm grip, blue
thermoplastic



PO
Maniglia a ponte -
Multi-settore, Foro
liscio

Prodotti correlati



PRF_FIX_UNI
Fissaggio, universale



PRF19_E
Squadra di giunzione,
PRF19 a PRF32