

# Lip seal for panel

PRFJL **MiniTec** For 2mm thick panels

- Material: black EPDM
- Seal sold by the metre

## Uses

- For supporting and sealing 2mm thick panels in profile slots
- Should not be used with acrylic or polycarbonate panels

## Assembly

- Place the panel in the profile slot
- Insert the lip seal
- Press seal into place with suitable blunt tool
- For panels thinner than 2mm, use 2 PRF-JL-6 seals on either side of the panel instead.

## Info.

- Max length available 200m
- Panels: Add 25mm to height and width of aperture to ensure panel will be supported correctly

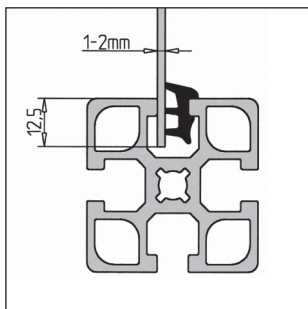
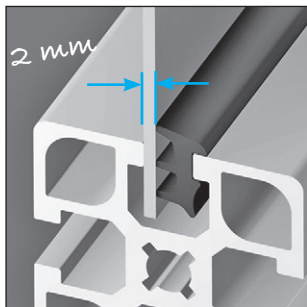

Assembly example

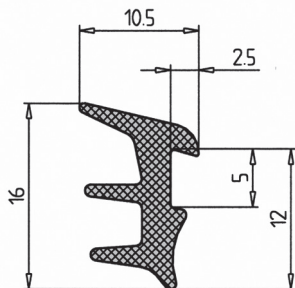

## DISCOUNTS

Qty.	1+	50+	100+
Disc.	List -5%	On request	

Part number	Type	Weight (kg/m)	Price per metre
PRF-JL-2	Lip seal	0,092	3,17 €

Dimensions in mm

## Altri prodotti...



WSRM

Dado cilindrico in polimero, Polimero (Iglidur®) - 1 filetto



BAC105

Contenitore a becco, 8mm



UCF\_SS

Cuscinetto a flangia quadrata tutto inox, Inox



PGT

Accessori per pannello, Profilo per pannello scorrevole



T25-6ECO

Puleggia dentata di posizionamento tipo T, Serie economica - T2.5 al...



AT10-32ECO

Puleggia dentata di posizionamento tipo AT, Serie economica - AT10 a...



AF

Giunto rigido con cava chiave, Set screw



PR85

Piede fissabile con snodo - poliammide, Ø 83



GG3

Ingranaggio dritto rettificato, Acciaio trattato

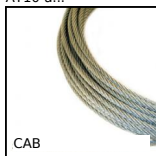

CAB

Cavo di fissaggio, Inox



PRF\_GAL

Rotella per profilo alluminio, Kit di fissaggio per rotella



LVT

Mini martinetto motorizzato 1A, 1 ampere

## Prodotti correlati



PRF4545

Profilato alluminio standard, 45 x 45 mm