



# Spur gear coaxial gearbox

Torque up to 20Nm

NT63  
NH63

- Ratios from 1:1 to 120:1 (other ratios available on request)
- Output backlash: N/A
- Max. input speed: 3000 rpm
- Materials:
  - casing: anodised aluminium
  - input & output: unhardened steel
- Weight: 0.64 kg

## Options

- Can be adapted to suit your motor
- Ask for the ratio you require
- Also see NT61, NH61 and NT62, NH62
- keyway conforms to DIN 6885

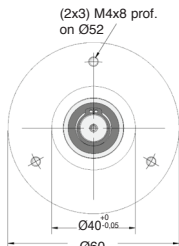
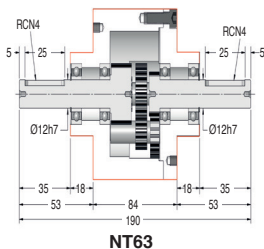
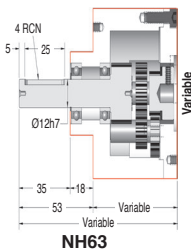

Output face

## OUTPUT TORQUE (In Nm, values given as a guide only)

Ratios	30:1	36:1	40:1	48:1	54:1	81:1	120:1
3000	8,0	9,0	9,0	9,0	9,0	10,0	10,0
2000	8,5	9,0	9,0	9,0	9,0	10,0	10,0
1000	9,0	10,0	10,0	10,0	10,0	10,0	10,0
500	10,0	11,0	11,0	11,0	11,0	11,0	11,0
200	12,0	12,0	12,0	12,0	12,0	12,0	12,0
100	14,0	14,0	14,0	14,0	14,0	14,0	14,0
50	16,0	17,0	17,0	17,0	17,0	17,0	17,0
20	19,0	20,0	20,0	20,0	20,0	20,0	20,0

Large choice of reduction ratios!  
Up to 120:1

## DISCOUNTS

Qty.	1+	2+	4+	6+
Disc.	List	-15%	-20%	On request

Part number	Ratios	Max. input speed (rpm)	Max. output speed (rpm)	Efficiency at 1000 rpm	Module	Direction of input/output rotation	Price each
NT63-30 NH63-30	30:1	3000	100	80%	Opposite	849,04 €	On request
NT63-36 NH63-36	36:1	3000	83	80%	Opposite	849,04 €	
NT63-40 NH63-40	40:1	3000	75	80%	Opposite	849,04 €	
NT63-48 NH63-48	48:1	3000	62	80%	Opposite	849,04 €	
NT63-54 NH63-54	54:1	3000	55	80%	Opposite	849,04 €	
NT63-81 NH63-81	81:1	3000	37	80%	Opposite	849,04 €	
NT63-120 NH63-120	120:1	3000	25	80%	Same	849,04 €	
NT63-SP NH63-SP	1:1 - 120:1	Special ratios from 1:1 to 120:1				947,21 €	

Dimensions in mm

## Altri prodotti...



FDS

Flexible drive shaft,  
Masterflex® Steel,  
with PVC casing



SH1

Ingranaggio elicoidale  
ad assi paralleli,  
Plastica lavorata  
(delrin)



DOMI50

Slitta di regolazione  
Domino 50, Slitta  
DOMILINE 50 con  
contatore e ...



GE\_ET\_2RS

Snodo sferico, Cromo  
duro/PTFE con  
guarnizioni di tenuta



M0

Coppia ruota e vite  
senza fine , Acciaio  
temprato



BABss

Perno autobloccante  
inox 303, Inox 303



GARQT

Perno di bloccaggio  
tipo ¼ di giro, ¼ di  
giro



SHW

Rondella semplice ,  
Acciaio



SERB

Serratura a camme,  
Serratura a camme



ACLEFS

Elementi di  
ancoraggio, Standard

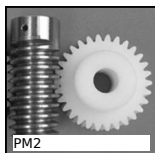

PM2

Coppia ruota e vite  
senza fine, Plastica  
lavorata (delrin)



NT122

Riduttore coassiale a  
treni paralleli, da 32 a  
85 Nm - a treni  
paral...

## Prodotti correlati



NT62

Riduttore coassiale a  
treni paralleli, da 6 a  
18 Nm - a treni  
parall...



NT91

Riduttore coassiale a  
treni paralleli, da 10 a  
35 Nm - a treni  
paral...