



# Spur gear coaxial gearbox

**Torque up to 85Nm**

**NT122  
NH122**

- Ratios from 1:1 to 27:1 (other ratios available on request)
- Output backlash: N/A
- Max. input speed: 3000 rpm
- Materials:
  - casing: anodised aluminium
  - input & output: unhardened steel
- Weight: 2.6 kg



## Options

- Can be adapted to suit your motor
- Ask for the ratio you require
- Also see NT121, NH121
- keyway conforms to DIN 6885

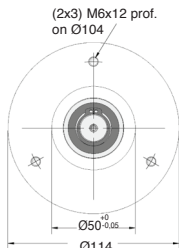
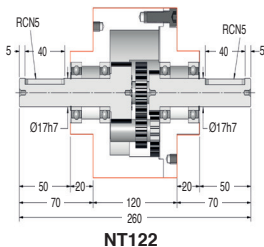
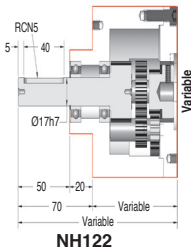

Output face

## OUTPUT TORQUE (In Nm, values given as a guide only)

|                   | Ratios | 10:1 | 12:1 | 15:1 | 18:1 | 24:1 | 8:1 |
|-------------------|--------|------|------|------|------|------|-----|
| INPUT SPEED (rpm) | 3000   | 32   | 32   | 32   | 32   | 32   | 32  |
|                   | 2000   | 36   | 36   | 36   | 36   | 36   | 36  |
|                   | 1000   | 42   | 42   | 42   | 42   | 42   | 42  |
|                   | 500    | 49   | 49   | 49   | 49   | 49   | 49  |
|                   | 200    | 54   | 54   | 54   | 54   | 54   | 54  |
|                   | 100    | 61   | 61   | 61   | 61   | 61   | 61  |
|                   | 50     | 73   | 73   | 73   | 73   | 73   | 73  |
|                   | 20     | 85   | 85   | 85   | 85   | 85   | 85  |

**Large choice of reduction ratios!  
Up to 27:1**

## DISCOUNTS

| Qty.  | 1+   | 2+   | 4+   | 6+         |
|-------|------|------|------|------------|
| Disc. | List | -15% | -20% | On request |

| Part number       | Ratios     | Max. input speed (rpm)                 | Max. output speed (rpm) | Efficiency at 1000 rpm | Module   | Direction of input/output rotation | Price each        |
|-------------------|------------|--|-------------------------|------------------------|----------|------------------------------------|-------------------|
| NT122-10 NH122-10 | 10:1       | 3000                                   | 300                     | 88%                    | Opposite | 1 097,17 €                         | <b>On request</b> |
| NT122-12 NH122-12 | 12:1       | 3000                                   | 250                     | 88%                    | Opposite | 1 097,17 €                         |                   |
| NT122-15 NH122-15 | 15:1       | 3000                                   | 200                     | 88%                    | Opposite | 1 097,17 €                         |                   |
| NT122-18 NH122-18 | 18:1       | 3000                                   | 166                     | 88%                    | Opposite | 1 097,17 €                         |                   |
| NT122-24 NH122-24 | 24:1       | 3000                                   | 125                     | 88%                    | Opposite | 1 097,17 €                         |                   |
| NT122-27 NH122-27 | 27:1       | 3000                                   | 111                     | 88%                    | Opposite | 1 097,17 €                         |                   |
| NT122-SP NH122-SP | 1:1 - 27:1 | <b>Special ratios from 1:1 to 27:1</b> |                         |                        |          | 1 164,96 €                         |                   |

Dimensions in mm

## Altri prodotti...



HTD5M\_25

Puleggia dentata di trasmissione tipo HTD, HTD5 Alluminio



DCA

Ventosa, silicone



RTK

Giunto Bowex®, a dentatura bombata, Nylon e acciaio



VB

Volantino a 6 lobi, Duroplast - Ottone



PTA40

Piede snodato con base stampata Ø40, 3000N



LBE

Manicotto a sfere Mini, Miniatura



PGR

Impugnatura cilindrica libera retraibile, Retraibile



SH0

Ingranaggio elicoidale ad assi paralleli, Acciaio 20NCD2



VELM6

Supporto avvitabile per rotolo a strappo farmacavi,



BABV

Ball lock pins lockable, Stainless steel



BCH\_SS

Pomello a fungo inox, M3 a M8



MDB\_MTB

Ingranaggio conico in plastica stampata, 3:1

## Prodotti correlati



NT121

Riduttore coassiale a treni paralleli, da 20 a 68 Nm - a treni paral...



NT92

Riduttore coassiale a treni paralleli, da 15 a 40 Nm - a treni paral...