

Rectangular Master-Plate® glueable insert

316L stainless steel

MSP

- Glueable stainless steel plate with tapped insert or threaded stud
- Material:
316L stainless steel

Applications

- Industrial, transport, building, furnishings

Info.

- Glue not supplied
- Not supplied individually, contact us for details

316L stainless steel



316L stainless steel

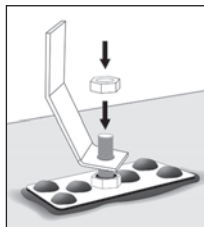
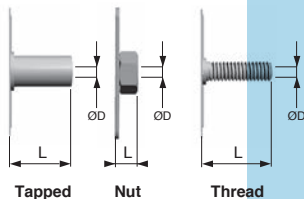
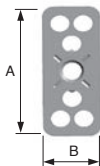

Typical application

DISCOUNTS

Qty	1+	50+	100+	500+
Disc.	List	-10%	-20%	On request

Part number	A	B	ØD	L	Form	Price each 1 to 49
MSP3815T-6-5/SS	38	15	M6	5	Tapped	5,82 €
MSP3815E-5-4/SS	38	15	M5	4	Nut	2,05 €
MSP3815E-6-5/SS	38	15	M6	5	Nut	2,31 €
MSP3815E-8-6/SS	38	15	M8	6,5	Nut	2,50 €
MSP3815F-5-12/SS	38	15	M5	12	Thread	2,16 €
MSP3815F-5-16/SS	38	15	M5	16	Thread	2,21 €
MSP3815F-6-16/SS	38	15	M6	16	Thread	2,24 €
MSP3815F-6-20/SS	38	15	M6	20	Thread	2,29 €

Dimensions in mm

0 825 88 6000
Service 0,15 € / min
+ prix appel

Fax

cial2@hpceurope.com **HPC** SUPPLEMENT 2019

81

Altri prodotti...



BAC110

Contenitore a becco,
Contenitore



BZY_SS

Antivibrante elastico
cilindrico inox, Inox



SLS

Supporto per vite
trapezoidale,
Supporto Drylin®
frottante



PRF-SCREEN-4

Screen support,
Support with 4 axes of
rotation



BOX-SHNA

Dado esagonale -
DIN934, Valigetta di
dadi acciaio



VLBS

Anello di
sollevamento,
Articolato - a saldare



ACM_DZ

Base per tirante
chiusura in gomma,
Base



J52

Riduttore coassiale a
treni paralleli, da 0.27
a 0.90 - a treni para...



NTM

Grano punta in nylon,
punta in nylon



PDR-RD

Piede con ruota
integrata, Ruota
disassata



ZG0

Ingranaggio dritto in
plastica, Plastica
lavorata (delrin)



CHAsb28

Cerniera senza perno
in rotoli, Cerniera in
polimero

Prodotti correlati



MSP3815

Inserto con piastrina a
incollare
Masterplate®,
rettangolare con in...



MSP38

Inserto con piastrina a
incollare
Masterplate®,
Cilindrico Ø38 con...



MSP23

Inserto con piastrina a
incollare
Masterplate®,
Cilindrico Ø23 con...



MSP3815

Inserto con piastrina a
incollare
Masterplate®,
rettangolare con dado