

Material : steel (with high elastic limit)

- Notches : 4 at 90° spacing
- Screw(s) : Flat headed Hc (class 14.9)
- Standard finish :
- Right handed threads (class 4H) . Ground working face
- Engraved on reverse face . Blackened finish



Clamping key
Front tightening,
1 spring



Self-locking

Application

- The LF locking nut can be used wherever radial clamping is not possible. It is particularly recommended for components mounted inside holes or deep bores.
- The axial force created by the tightening of the screw is transmitted at 90° by the edges.
- The resulting radial force is applied to the clamping spring
- The contact surface perpendicular to the threaded side allows the adjustment and locking in place of different bearings or other mechanical elements requiring positioning under very precise tolerances.
- In addition to the lateral notches, the holes located on the front face allow positioning of the nut using a suitable spanner.

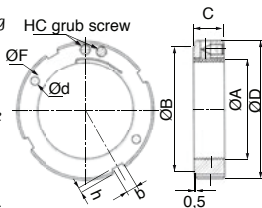

Info.

- * Following locking values were obtained for different sizes of locking screw
- M4 screw 2.5Nm torque • M5 screw 5Nm torque
- M6 screw 8 Nm torque • M8 screw 18Nm torque

DISCOUNTS

Qty	1+	6+	21+
Disc.	Prix -10%		On request

Part number	Thread	ØA	ØD	ØB	C	b x h	ØF	Ød	Screw HC*	Unlocking torque (Nm)	Max axial load (N)	Weight (kg)	Price each 1 to 5
LF-1	12 x 1,0	28	22	15	4 x 2,0	20	3,2		1 screw M4	4	36200	0,050	63,83 €
LF-2	14 x 1,0	30	25	15	4 x 2,0	22	3,2	6		42600	0,055	69,21 €	
LF-3	15 x 1,0	31	26	15	4 x 2,0	23	3,2	6	51500	0,060	74,65 €		
LF-4	17 x 1,0	33	28	15	4 x 2,0	26	3,2	7	58700	0,065	75,13 €		
LF-5	18 x 1,0	34	29	15	4 x 2,0	26	3,2	9	55400	0,070	75,13 €		
LF-6	20 x 1,0	37	32	15	4 x 2,0	29	3,2	10	61800	0,080	75,63 €		
LF-7	22 x 1,5	39	34	15	4 x 2,0	30	3,2	12	64700	0,090	76,11 €		
LF-8	25 x 1,5	43	38	15	5 x 2,0	33	4,2	15	80200	0,100	76,60 €		
LF-9	30 x 1,5	48	43	15	5 x 2,0	39	4,2	20	100600	0,120	77,08 €		
LF-10	32 x 1,5	50	45	15	5 x 2,0	41	4,2	24	113500	0,125	82,01 €		
LF-11	35 x 1,5	53	48	15	5 x 2,0	44	4,2	29	118500	0,140	86,90 €		
LF-12	38 x 1,5	56	51	15	5 x 2,0	47	4,2	35	124500	0,145	87,93 €		
LF-13	40 x 1,5	58	52	15	6 x 2,5	50	4,2	41	127100	0,150	93,81 €		
LF-14	42 x 1,5	62	56	15	6 x 2,5	52	4,2	45	131300	0,175	98,70 €		
LF-15	45 x 1,5	65	59	15	6 x 2,5	55	4,2	55	143400	0,185	99,67 €		
LF-16	50 x 1,5	69	63	15	6 x 2,5	59	4,2	70	165200	0,190	102,15 €		
LF-17	52 x 1,5	72	66	15	6 x 2,5	62	4,2	85	171900	0,215	106,56 €		

Dimensions in mm

Advantages

- An accurate and strong solution for securing bearings in their axial position after installation.
- Locking washers are no longer required thus reducing the risk of seal damage.
- The rings can be clamped and locked in place with no loss of axial precision.
- Suitable for use in hostile environments (temperature, vibration etc...).
- All threading and contact face machining operations are performed in one operation to ensure that squareness and minimum run-out is guaranteed.

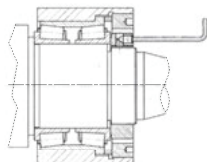

Typical application – Installation of a taper bearing on a machine tool spindle

Assembly

- The rings are screwed into position using an appropriately sized pin spanner (DIN 1810) on the lateral slots.
- To disassemble, simply unscrew.

Info.

- The values of locking torque and axial load given are for static assemblies. They are indicative purposes only and we decline any responsibility.

NEW!

Part number	Thread ØA	ØD	ØB	C	b x h	ØF	Ød	Screw HC*	Unlocking torque (Nm)	Max axial load (N)	Weight (kg)	Price each 1 to 5
LF-18	55 x 2	75	68	15	7 x 3,0	65	4,2	2 M5	105	241300	0,23	63,83 €
LF-19	60 x 2	80	73	20	7 x 3,0	72	4,2		130	263800	0,33	69,21 €
LF-20	65 x 2	85	78	20	7 x 3,0	76	4,2		160	291000	0,35	74,65 €
LF-21	70 x 2	90	82	20	8 x 3,5	81	4,2		200	313900	0,36	75,13 €
LF-22	75 x 2	95	87	20	8 x 3,5	86	4,2	2 M6	220	347800	0,39	75,13 €
LF-23	80 x 2	105	97	20	8 x 3,5	93	5,2		240	371300	0,55	75,63 €
LF-24	85 x 2	110	102	20	8 x 3,5	98	5,2		250	394900	0,57	76,11 €
LF-25	90 x 2	115	106	20	10 x 4	104	5,2		265	422500	0,60	76,60 €
LF-26	95 x 2	120	111	20	10 x 4	107	5,2		295	446300	0,63	77,08 €
LF-27	100 x 2	125	116	20	10 x 4	114	5,2		325	470200	0,65	82,01 €
LF-28	105 x 2	130	119	20	12 x 5	118	5,2		365	494000	0,68	86,90 €
LF-29	110 x 2	135	124	20	12 x 5	122	5,2		405	517800	0,72	87,93 €
LF-30	115 x 2	140	129	20	12 x 5	127	5,2	2 M8	450	545000	0,75	93,81 €
LF-31	120 x 2	145	134	20	12 x 5	132	5,2		500	574300	0,78	98,70 €
LF-32	125 x 2	150	139	20	12 x 5	137	5,2		560	598500	0,80	99,67 €
LF-33	130 x 2	155	144	20	12 x 5	142	5,2		635	626600	0,85	102,15 €
LF-34	135 x 2	165	152	22	14 x 6	150	6,2		680	723300	1,15	106,56 €
LF-35	140 x 2	170	157	22	14 x 6	155	6,2		1065	761900	1,20	320,76 €
LF-36	145 x 2	175	162	22	14 x 6	160	6,2		1065	789300	1,25	331,54 €
LF-37	150 x 2	180	167	22	14 x 6	165	6,2	1065	821700	1,30	341,80 €	

Dimensions in mm

Altri prodotti...



GCT
Copiglia per tubo, Clip per tubo



RPCplss
Ruota fissa con piastra, Inox - Poliammide



AFM
Cuscinetto a collare, Polimero alimentare



MEF
Cuscinetto cilindrico, Lega di ferro FP20 autolubrificante METAFRAM



BAC105
Contenitore a becco, 8mm



PSG25
Ingranaggio dritto di precisione, Acciaio 35NCD6 pretrattato



CTZYSS
Antivibrante elastico inox sfolato, Inox



BOX-TOR-ORFS
Valigetta di guarnizioni toriche in nitrile, 7.65 x 1.78mm a 37.82 x...



PR880
Ruota di rinvio, Serie 880



PCH
Impugnatura, Fungo



RAS
Snodo angolare a 90° DIN71802, Inox



BAB
Perno autobloccante a sfere, Inox temprato

Prodotti correlati



LR
Cuscinetto a sfere - Accessorio, Ghiera di regolazione

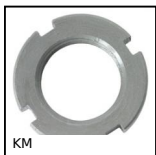

KM
Cuscinetto a sfere - Accessorio, Ghiera KM