

# Decorative rigid latch clamp

## GAE

### With or without key

- Snap closing
- Supplied with 2 identical keys for the key versions
- Supplied with catch plate
- Material:
  - Die cast zinc black coating

**NEW!**



With or without key

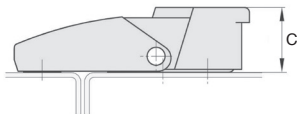
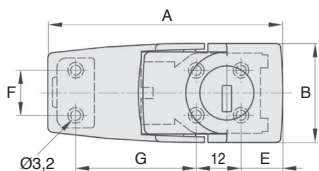

### DISCOUNTS

Qty	1+	10+	20+	50+
Disc.	List	-3%	-5%	On request

Part number	A	B	C	E	F	G	Weight (g)	Price each 1 to 9
<b>Without key</b>								
GAE17-64	64,5	26,5	17,3	13	12	30	72	
GAE21-76	76	32	21	16,8	16	35,5	118	
<b>With key</b>								
GAE17-64/K	64,5	26,5	17,3	13	12	30	72	
GAE21-76/K	76	32	21	16,8	16	35,5	118	

Dimensions in mm

## Altri prodotti...

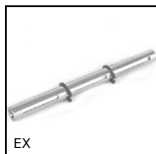

EX

Albero per riduttori E,  
Albero doppio per  
riduttori E



EMS

Volantino zigrinato,  
Zigrinato



GB-RA

Ingranaggio dritto  
ottone, Ottone  
CuZn39Pb3



GGB

Dado ad alette, Cieco



MDB\_MTB

Ingranaggio conico in  
plastica stampata ,  
3:1

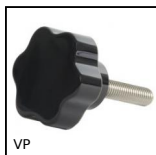

VP

Volantino a 6 lobi,  
Duroplast - Acciaio



S4

Pignone a catena -  
Inox, 4mm



HBM

Guida su semi-binari,  
Boccola di regolazione



SMLS

Tavola lineare, Per  
lunghezze ridotte



EBH

Dado cieco Hygienic  
Design®, Con collare

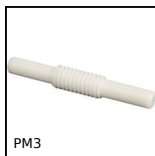

PM3

Vite senza fine,  
Plastica lavorata

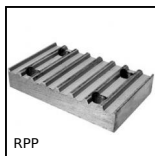

RPP

Piastra di giunzione  
per cinghia RPP, RPP8

**Prodotti correlati**