

- Gearbox type: worm and wheel
- Bearing: self-lubricating bushes
- Angular backlash: N/A
- Max. axial load: N/A
- Max. radial load: N/A
- Working temp. from -40°C to +80°C
- Min. weight: 1.25kg
- Motor does not exhibit anti back drive behaviour for efficiencies less than 50%

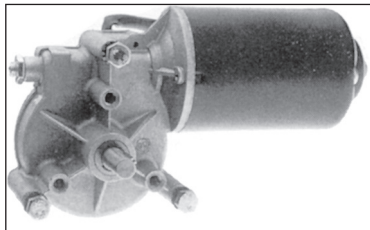

### Accessories

- Servo Amplifier **FIRSTDC-1Q-60/10**
- Speed controller **NANODC-1Q-30/3**
- Power Supplies **ALIDR60-24, ALIDR120-24**

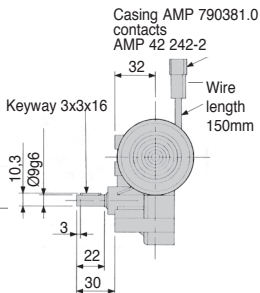
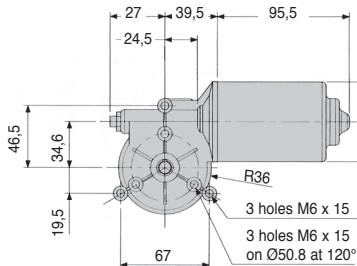

### DISCOUNTS

Qty.	1+	6+	10+
Disc.	List	-7%	On request

Part number	Ratios	Efficiency (%)	Unloaded speed (rpm)	Loaded speed (rpm)	Nominal torque (Nm)	Nominal current (mA)	Price each 1 to 5
<b>12 V DC Version</b>							
DOG111-12-135	12,2:1	60	135	105	1,5	4,0	251,58 €
DOG111-12-50	62,0:1	45	50	40	5,0	5,0	135,44 €
DOG111-12-34	62,0:1	45	34	25	6,0	4,0	135,44 €
DOG111-12-17	62,0:1	45	17	10	6,0	2,0	138,23 €
<b>24 V DC Version</b>							
DOG111-24-270	12,2:1	60	270	240	1,5	4,0	251,58 €
DOG111-24-78	62,0:1	45	78	70	3,0	3,0	149,26 €
DOG111-24-50	62,0:1	45	50	40	5,0	2,5	143,73 €
DOG111-24-34	62,0:1	45	34	25	6,0	2,0	138,23 €

Dimensions in mm

## Altri prodotti...



PAL

Dado di sicurezza, Per bloccaggio assiale



PP60

Riduttore a ruota e vite senza fine, da 17.80 a 34 Nm



BOX-TOR-D

Valigetta di guarnizioni toriche in nitrile, 18.00 x 2.00mm a 50.00 ...



CHM40

Riduttore a ruota e vite senza fine, fino a 57 Nm



INS\_SS

Inserto auto-fillettante, Inox 316



CHTRB

Riduttore a rinvio angolare a L o a T, fino a 87,3 Nm



AFSE

Perno di fissaggio, con chiusura a scatto



RLXAC8

Rullo folle, Acciaio



BTC\_M

Tappo per tubo quadrato con inserto maschiato, Con inserto maschiato



PRF\_PA

Elementi di giunzione, Piastra di adattamento



INS\_BR

Boccola autofillettante Ottone, Ottone



BABPass

Perno autobloccante inox temprato ad anello, Con impugnatura ad anello

## Prodotti correlati

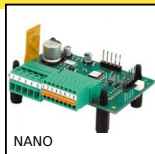

NANO

Variatore di velocità 3A, 3 A



MDPOT

Potenzimetro,