



# Socket with protective insert

Hygienic Design® and Usit®

DEP-HD

## - Socket with protective plastic insert for mounting Hygienic Design® and Usit® products

### - Materials:

Socket: tool steel

Insert: special PETP

## Advantages

- 1/2" drive socket with a plastic insert to tighten and loosen screws and nuts in the Hygienic range. The plastic insert is made of special PETP and is FDA approved. The inserts are pressed into the socket by hand. Their special shape, combined with a clamping device, ensures optimal retention inside the socket.
- No special tools are required to replace worn plastic inserts.
- With a tightening torque (according to DIN standard for A4-70 screws and nuts, friction coefficient 0.12 $\mu$ ) the inserts plastic have a life span of up to 1,000 cycles or more.

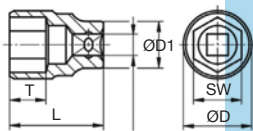

□12,5(1/2")

DEP/HD socket

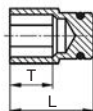

DEP/HD/INS insert

## DISCOUNTS

Qty	1+	5+	10+
Disc	Net	-5%	On request

Part N°	ØD	ØD1	L	T	SW	SW1	Suitable for hexagonal screw	Price each
								1 to 4
<b>Socket</b>								
DEP-11/HD	16,6	22	37,3	10,1	11	-	-	25,65 €
DEP-13/HD	19,1	22	37,3	10,6	13	-	-	25,52 €
DEP-16/HD	22,9	23,6	37,1	11,3	16	-	-	26,87 €
DEP-19/HD	26,6	23	37,0	13,2	19	-	-	27,77 €
DEP-21/HD	29,0	25	36,8	12,9	21	-	-	43,21 €
DEP-27/HD	35,2	25	44,4	18,1	27	-	-	51,06 €
<b>Protective insert</b>								
DEP-8/HD/INS	-	-	18,0	6	11	8	M5	8,45 €
DEP-10/HD/INS	-	-	19,5	10	13	10	M6	8,52 €
DEP-13/HD/INS	-	-	21,5	11	16	13	M8	9,35 €
DEP-16/HD/INS	-	-	22,0	13,5	19	16	M10	9,82 €
DEP-18/HD/INS	-	-	21,5	12	21	18	M12	10,16 €
DEP-24/HD/INS	-	-	26,5	18	27	24	M16	14,51 €

All dimensions in mm

0 825 88 6000

Service 0,15 € / min  
+ prix appel

Fax

cial2@hpceurope.com

HPC

SUPPLEMENT 2019

61

## Altri prodotti...



BGC

Giunto Oldham, con ganascia di serraggio



BLHM60

Rinvio angolare, fino a 70 Nm



BFA

Anelli d'arresto per alberi, Anello tipo E



PT880

Pignone di trazione, Serie 880



NTMdi

Grano punta in delrin, punta in delrin



WJUM10

Pattino Drylin® W, Pattino



BH02

Cuscinetto radiale flangiato, Montaggio con circlips



CMM

Testa a snodo maschio DIN ISO12240-4, Acciaio / bronzo



ESST

Base di sostegno, Trepiede



BPM\_LOK

Pressore a molla con intaglio e puntale a sfera, LONG-LOK - Inox 303



ZHG6

Ingranaggio dritto in plastica, Plastica lavorata (delrin)



CABma

Manicotto ovale per cavo, Per la crimpatura di un cavo in acciaio

**Prodotti correlati**