



# Socket with protective insert

Hygienic Design® and Usit®

DEP-HD

## - Socket with protective plastic insert for mounting Hygienic Design® and Usit® products

### - Materials:

Socket: tool steel

Insert: special PETP

## Advantages

- 1/2" drive socket with a plastic insert to tighten and loosen screws and nuts in the Hygienic range. The plastic insert is made of special PETP and is FDA approved. The inserts are pressed into the socket by hand. Their special shape, combined with a clamping device, ensures optimal retention inside the socket.
- No special tools are required to replace worn plastic inserts.
- With a tightening torque (according to DIN standard for A4-70 screws and nuts, friction coefficient 0.12 $\mu$ ) the inserts plastic have a life span of up to 1,000 cycles or more.

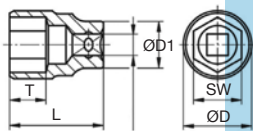

□12,5(1/2")

DEP/HD socket

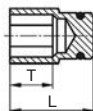

DEP/HD/INS insert

## DISCOUNTS

Qty	1+	5+	10+
Disc	Net	-5%	On request

Part N°	ØD	ØD1	L	T	SW	SW1	Suitable for hexagonal screw	Price each
								1 to 4
<b>Socket</b>								
DEP-11/HD	16,6	22	37,3	10,1	11	-	-	25,65 €
DEP-13/HD	19,1	22	37,3	10,6	13	-	-	25,52 €
DEP-16/HD	22,9	23,6	37,1	11,3	16	-	-	26,87 €
DEP-19/HD	26,6	23	37,0	13,2	19	-	-	27,77 €
DEP-21/HD	29,0	25	36,8	12,9	21	-	-	43,21 €
DEP-27/HD	35,2	25	44,4	18,1	27	-	-	51,06 €
<b>Protective insert</b>								
DEP-8/HD/INS	-	-	18,0	6	11	8	M5	8,45 €
DEP-10/HD/INS	-	-	19,5	10	13	10	M6	8,52 €
DEP-13/HD/INS	-	-	21,5	11	16	13	M8	9,35 €
DEP-16/HD/INS	-	-	22,0	13,5	19	16	M10	9,82 €
DEP-18/HD/INS	-	-	21,5	12	21	18	M12	10,16 €
DEP-24/HD/INS	-	-	26,5	18	27	24	M16	14,51 €

All dimensions in mm

0 825 88 6000

Service 0,15 € / min  
+ prix appel

Fax

cial2@hpceurope.com

HPC

SUPPLEMENT 2019

61

## Altri prodotti...



HTD14M\_85  
Puleggia dentata di trasmissione tipo HTD, HTD14 Acciaio



SEH  
Attrezzo di bloccaggio a tirante, A tirante - inox



MSP38  
Inserto con piastrina a incollare Masterplate®, Cilindrico Ø38 con...



UTKswrr  
Guida lineare Utilitrack®, Profilo guida a V



RLR  
Tenditore per catene Roll-Ring®, Roll-Ring® Self-adjusting



CHAEss  
Cerniera estetica, Inox



AC156-157  
Riscontro per chiusura a leva rigida ad anello, 25.5mm



GET-AL  
Giunto elastico alluminio serie eco., Alluminio



SRG  
Chiusura a leva regolabile, Corsa da 117,4mm a 128mm



ZG3  
Ingranaggio dritto in plastica, Plastica lavorata (delrin)



PW\_PWG3  
Ruota di precisione, Bronzo



AT5courroie  
Cinghia chiusa posizionamento AT, AT5 Poliuretano armatura in acciaio

## Prodotti correlati



EBC  
Dado cieco Hygienic Design®, Compatto



VHTM  
Hexagonal headed bolt Hygienic Design®, Inox