

- Indexing lever with male thread and collar for a sealing washer

- EHEDG certification
- Material:
Stainless steel 1.4404 (316L)
Polished finish up to Ra<0.04

Advantages

- Intended for use in hygienic environments. The completely sealed handle and a gasket prevent contamination inside the lever.
- In addition, the insert is fitted with a conical collar so that the screwed connection can be hygienically sealed to the sealing washer.
- The lever rotates freely when not in use.

Accessory

- RDE sealing washers
(cf. pages 37 à 39)



Apply pressure to engage the lever (safety feature)

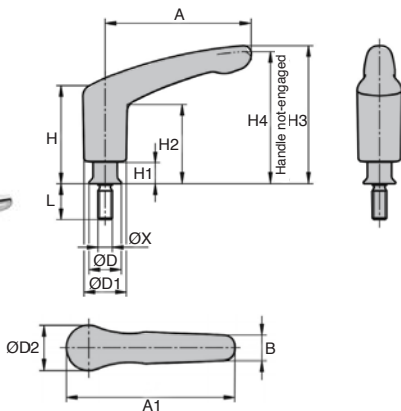

DISCOUNTS

Qty	1+	5+	10+
Disc.	Net	-5%	On request

Part N°	ØX	L	ØD	ØD1	ØD2	H	H1	H2	H3	H4	A	A1	B	N° of teeth	Price each
															1 to 4
CLA03T8/HUSS	M8	30	18	23,6	24,9	54,7	12,1	44	77	73,5	81,5	94	14,2	20	71,61 €
CLA03T10/HUSS	M10	40	22,3	23,6	24,9	54,7	12,1	44	77	73,5	81,5	94	14,2	20	75,22 €

All dimensions in mm

0 825 88 6000

Service 0,15 € / min
+ prix appel

Altri prodotti...



BSPT
Morsetto per guide,
Rondo



CHB
Riduttore a ruota e
vite senza fine, fino a
22 Nm



BEAB
Manopola, stella, anti-
bacterial



RBNTc
Ruota girevole a foro
centrale, Acciaio -
caucciù



PFC
Piede fisso,
Livellamento per
piccoli elementi

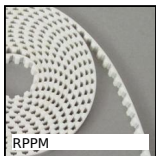

RPPM
Cinghia aperta al
metro tipo RPP, RPP14
Poliuretano armatura
in acci...



CHAR16046
Cerniera a molla,
avvitabile



TM_CTM_CTF
Accessori per ventosa,
Inserto per ventosa -
A scatto



BH01
Cuscinetto radiale
flangiato, Montaggio :
pressione e colla



ZBconique
Ingranaggio conico in
plastica, 1:1

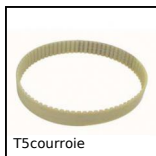

T5courroie
Cinghia di
posizionamento T, T5
Poliuretano armatura
in acciaio



BSM_LOK
Pressore a molla con
esagono incassato,
LONG-LOK - corpo e
spina in ...

Prodotti correlati



RDE-W
Rondella di tenuta
Hygienic Usit®, Inox -
EPDM bianco



RDE-B
Rondella di tenuta
Hygienic Usit®,
Stainless steel - EPDM
blu



CLA
Maniglia a ripresa
Hygienic Usit®, Inox