

Mechanical motor drive

CHV

With 4 pole motor

- **Reduction ratio 1:5**
- With 4 pole motor, 1,400 RPM 230/400V
- B5 mounting flange
- **Materials:**
 - Aluminium for sizes 02, 05 and 10
 - Cast iron for size 20
- Paint : grey RAL 9022



Advantages

- Simple speed adjustment by a mechanical handle
- Good efficiency

Use

- The drives are supplied with lubrication for horizontal use
- Attention: supplied with motor only
- **Do not adjust the handle when the motor-drive is not connected to the final device: risk of irreversible damage.**

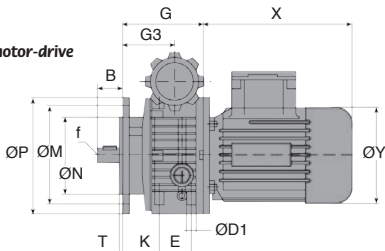

Part number	Motor power kW	Output speed (rpm)	Torque (Nm)	B	ØD1	E	G	G3
CHV02-0.18	0,18	170-880	3-1,5	23	M6	50	112,5	64,5
CHV02-0.22	0,22	170-880	3,8-1,9	23	M6	50	112,5	64,5
CHV05-0.37	0,37	200-1000	6-3	30	M8	40	110,0	74,0
CHV10-0.75	0,75	200-1000	12-6	40	M8	58	139,0	85,5
CHV20-1.10	1,1	200-1000	18-9	50	-	-	188,0	115,0
CHV20-1.50	1,5	200-1000	24-12	50	-	-	188,0	115,0

Part number	X	ØY	ØM	ØN	ØP	T	K	f
CHV02-0.18	192	130	115	95	140	3,5	46,0	M5
CHV02-0.22	192	130	115	95	140	3,5	46,0	M5
CHV05-0.37	225	145	130	110	160	3,5	52,5	M6
CHV10-0.75	250	165	165	130	200	3,5	60,0	M6
CHV20-1.10	205	185	165	130	200	3,5	-	M8
CHV20-1.50	205	185	165	130	200	3,5	-	M8

Dimensions in mm

Mechanical motor drive

With 4 pole motor

CHV

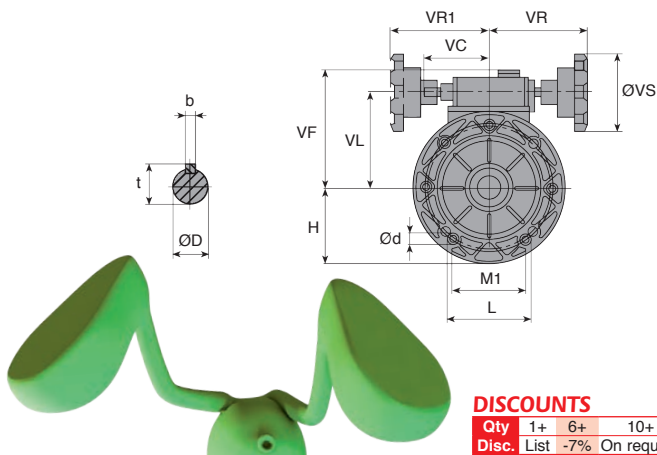

DISCOUNTS

Qty	1+	6+	10+
Disc.	List	-7%	On request

Part number	VC	VF	VL	VR	VR1	ØVS	Oil (kg)
CHV02-0.18	71	111	78	110	110	85	0,13
CHV02-0.22	71	111	78	110	110	85	0,13
CHV05-0.37	71	123	90	110	110	85	0,15
CHV10-0.75	79	140	107	120	120	110	0,33
CHV20-1.10	-	144	122	150	-	110	0,80
CHV20-1.50	-	144	122	150	-	110	0,80

Part number	M1	L	H	Ød	ØD (j6)	t	b	Weight (kg)	Price each 1 to 5
CHV02-0.18	60	72	70	9	11	12,5	4	3,4	403,74 €
CHV02-0.22	60	72	70	9	11	12,5	4	3,4	412,06 €
CHV05-0.37	76	90	80	9	14	16,0	5	4,7	492,89 €
CHV10-0.75	84	98	100	11	19	21,5	6	7,8	656,10 €
CHV20-1.10	-	241	126	11	24	27,0	8	31,0	973,60 €
CHV20-1.50	-	241	126	11	24	27,0	8	31,0	1 017,94 €

Dimensions in mm

Fax 0 825 88 6000
Service 0,15 € / min
+ prix appel

cial2@hpceurope.com

HPC

SUPPLEMENT 2019

107

Altri prodotti...



CHMR75

Riduttore a ruota e vite senza fine, fino a 298 Nm



BPTRW

Piastra inox a saldare tonda, A saldare

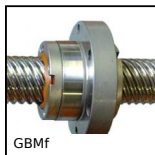

GBMf

Dado per vite a sfere, Dado flangiato a circuiti multipli



BCM_MPBT

Spazzola cilindrica modulare, Filo poliestere PBT



PRS100

Piede snodabile tutto inox Ø100, Ø 100



BOX-TOR-B

Valigetta di guarnizioni toriche in nitrile, 20.38 x 1.78mm a 50.16 ...



PSG255

Ingranaggio dritto di precisione, Inox 303



MSP38

Inserto con piastrina a incollare Masterplate®, Cilindrico Ø38 con...



PSG25

Ingranaggio dritto di precisione, Inox 316



G1

Ingranaggio dritto acciaio, Acciaio 20NCD2



SEV

Attrezzo di bloccaggio a tirante, A tirante verticale - inox



SH3

Ingranaggio elicoidale ad assi paralleli, Plastica lavorata (delrin)

Prodotti correlati



CHT

Motore AC asincrono trifase, 0.09kW



CHMR40

Riduttore a ruota e vite senza fine, fino a 57 Nm



CHM50

Riduttore a ruota e vite senza fine, fino a 107 Nm