

## Rapporto 1:1

## Acciaio C43

**Serie economica**

- Modulo da 1,5 a 5
- Dentatura a norma DIN 3967, tranne modulo 1 dentatura Gleason
- Angolo di pressione 20°
- Materiale:  
Acciaio C43
- Per una coppia, occorrono due pezzi



### Info.

- \*\*Prealesaggio fornito a titolo indicativo può variare in funzione della produzione

### SCONTI PER QUANTITÀ

Qtà	1+	4+	10+
Sc.	Prezzo	-5%	Su richiesta

Codice	Denti		ØD <sub>p</sub>	ØD <sub>e</sub>	F	L	ØD <sub>m</sub>	Prealesaggio non garantito				Lm	Stock*	Unit. da 1 a 3
	Z	Mod						ØA**	V	S	ØA**			
B1-16/ECO	16		16	17,4	4,0	11,2	13,3	4	4,80	-	6,5	-	-	
B1-19/ECO	19		19	20,4	4,0	11,8	15,3	4	6,20	-	6,5	-	-	
B1-22/ECO	22	1	22	23,4	4,7	12,8	16,3	5	7,20	-	6,5	-	-	
B1-26/ECO	26		26	27,4	5,5	13,3	20,3	5	8,70	-	7,0	-	-	
B1-30/ECO	30		30	31,4	6,4	16,0	20,3	5	10,0	-	8,0	-	-	
B1.5-16/ECO	16		24	26,12	6,0	18,9	20,3	8	7,10	-	12,0	✓	17,91 €	
B1.5-20/ECO	20	1,5	30	32,12	10,0	20,0	22,0	10	7,40	2,0	8,5	✓	21,63 €	
B1.5-25/ECO	25		37	39,62	10,0	23,0	28,0	10	11,09	2,0	12,0	✓	25,81 €	
B1.5-30/ECO	30		45	47,12	12,0	25,0	30,0	12	13,35	2,5	12,0	✓	31,21 €	
B2-16/ECO	16		32	34,83	8,0	23,5	25,3	8	9,50	-	14,0	✓	21,17 €	
B2-20/ECO	20	2	40	42,83	12,0	25,0	32,0	10	10,78	3,0	12,0	✓	26,34 €	
B2-25/ECO	25		50	52,82	14,0	28,0	40,0	12	14,28	3,0	12,3	✓	42,17 €	
B2-30/ECO	30		60	62,83	16,0	30,0	50,0	12	17,78	3,0	12,8	✓	50,75 €	
B2.5-16/ECO	16		40,0	43,53	10,0	28,1	30,3	12	11,90	-	15,0	✓	32,18 €	
B2.5-20/ECO	20	2,5	50,0	53,53	12,0	30,5	40,0	12	15,43	3,5	16,0	-	42,17 €	
B2.5-25/ECO	25		62,5	66,00	15,0	33,5	50,0	15	19,48	3,5	16,0	✓	51,40 €	
B2.5-30/ECO	30		75,0	78,53	18,0	35,5	55,0	15	23,63	3,5	16,0	✓	60,65 €	
B3-16/ECO	16		48,0	52,25	12,0	31,7	40,3	12	14,30	-	18,0	✓	37,69 €	
B3-20/ECO	20	3	60,0	64,24	18,0	35,0	45,0	15	16,00	4,0	13,6	✓	46,84 €	
B3-25/ECO	25		75,0	79,24	20,0	38,0	55,0	15	22,00	4,0	16,0	✓	56,57 €	
B3-30/ECO	30		90,0	94,24	22,0	40,0	60,0	20	28,00	4,0	17,0	✓	68,38 €	

\*Nei limiti delle disponibilità - Dimensioni in mm

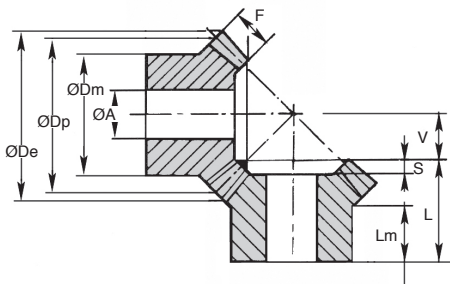

## SCONTI PER QUANTITÀ

Qtà	1+	4+	10+
Sc.	Prezzo	-5%	Su richiesta

Codice	Denti		ØD <sub>p</sub>	ØD <sub>e</sub>	F	L	ØD <sub>m</sub>	ØA**	V	S	L <sub>m</sub>	Stock*	Prezzo Unit.
	Z	Mod											
B3.5-16/ECO	16	3,5	56,0	60,95	14,0	36,4	45,3	16	16,60	-	20,0	✓	42,12 €
B3.5-20/ECO	20		70,0	74,95	22,0	40,5	55,0	15	18,13	4,5	17,0	-	51,32 €
B3.5-25/ECO	25		87,5	92,45	26,0	43,5	65,0	20	23,97	4,5	18,0	-	72,05 €
B3.5-30/ECO	30	4	105,0	109,95	30,0	48,0	70,0	20	30,02	4,5	19,0	-	84,01 €
B4-16/ECO	16		64,0	69,65	15,0	44,3	50,3	16	19,70	-	25,0	✓	49,43 €
B4-20/ECO	20		80,0	85,65	25,0	43,0	60,0	18	20,74	5,0	18,0	✓	61,47 €
B4-25/ECO	25	4,5	100,0	105,65	28,0	45,0	70,0	20	28,50	5,0	18,0	✓	77,66 €
B4-30/ECO	30		120,0	125,65	32,0	48,0	80,0	20	35,67	5,0	16,0	-	100,40 €
B4.5-16/ECO	16		72,0	78,38	17,5	46,3	55,3	20	21,70	-	25,0	-	54,66 €
B4.5-20/ECO	20	5	90,0	96,38	28,0	48,0	65,0	20	23,41	6,0	18,0	-	87,09 €
B4.5-25/ECO	25		112,5	118,80	32,0	50,0	75,0	20	31,76	6,0	18,0	-	105,87 €
B4.5-30/ECO	30		135,0	141,38	35,0	53,0	90,0	20	40,82	6,0	17,0	-	128,35 €
B5-16/ECO	16	5	80,0	87,07	18,0	48,9	60,3	20	25,10	-	25,0	✓	59,60 €
B5-20/ECO	20		100,0	107,07	30,0	50,5	70,0	20	26,86	6,5	18,5	✓	89,49 €
B5-25/ECO	25		125,0	132,07	34,0	53,5	90,0	20	36,36	6,5	18,0	✓	115,16 €
B5-30/ECO	30		150,0	157,07	38,0	56,5	110,0	20	45,97	6,17	18,0	✓	144,78 €

Dimensioni in mm

## Altri prodotti...



PRF\_BV

Blocchetto di fissaggio, Aggiunta e fissaggio di pannelli



PXHG25

Ingranaggio elicoidale ad assi incrociati, Acciaio 20NCD2 cementato temprato



CHA1056\_U12

Cerniera ad avvitare, Sezione 60X60



VTH

Vite a testa esagonale - DIN 933, Acciaio classe 8.8



CLAT

Maniglia a ripresa Hygienic Usit®, Inox



DOG111

Motoriduttore DC, da 1.5 a 6 Nm



R204

Molla per stampi, Medio



PTRSS

Pignone tendicatena, Per ambienti aggressivi



CLR

Molla a gas, Staffa di montaggio per forcella maschio



RURp

Ruota girevole a doppio bloccaggio, Poliuretano - Mozzo



PLMcr

Magnete, Con gancio



PITAss

Pistoncino a molla, con maniglia a T

## Prodotti correlati



MEB

Ingranaggio conico in plastica stampata (nylon), 1:1

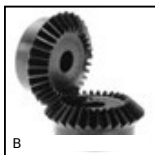

B

Ingranaggio conico - Acciaio 60C40, 1:1



ZBconique

Ingranaggio conico plastica lavorata (delrin), 1:1



SSB

Ingranaggio conico inox, 1:1