

Flange mounting ball transfer unit

Plastic

BPPE

- **Plastic ball mounting ball transfer unit**
- Push fit for rapid installation & replacement where only single-sided access to the mounting surface is available
- Clips compensate for irregularities in seat bore diameter
- Max. speed: 1m/s
- Working temperature range: -20 to +70°C
- Materials:
Acetal body and balls (POM)

Advantages

- Resists salt water and chemical attacks
- Non-conductive and non-magnetic
- Suitable for antimicrobial applications
- For use in chemical, pharmaceutical and medical applications

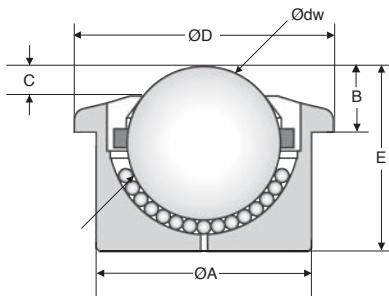

DISCOUNTS

Qty	1+	6+	20+	40+	60+
Disc.	Net	-10%	-15%	-20%	On request

Part N°	Ødw ball	ØA	B	C	ØD	E	Carrying capacity (kg)	Weight (g)	Price each 1 to 5
BPPE15-24/PP	15	24	8,0	4,8	30	20,0	7	0,010	18,29 €
BPPE22-36/PP	22	36	9,8	4,5	45	30,5	10	0,035	27,43 €
BPPE30-45/PP	30	45	13,8	5,8	55	37,0	15	0,065	32,65 €
BPPE45-62/PP	45	62	19,0	8,5	75	53,5	20	0,182	72,36 €

All dimensions in mm

0 825 88 6000
Service 0,15 € / min
+ prix appel

Fax

cial2@hpceurope.com

HPC

SUPPLEMENT 2019

255

Altri prodotti...



DBL820
Rotella per catena,
Serie 820 e 815



MPE
Distanziatore
esagonale, Acciaio

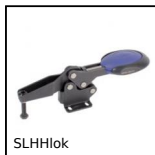

SLHHlok
Bloccaggio a leva, A
leva orizzontale / base
orizzontale



CHINV2
Cerniera invisibile,
Invisibile - Apertura
fino a 125°



PGNT
Impugnatura
termoplastica a T, Con
inserto maschiato



CHMR50
Riduttore a ruota e
vite senza fine, fino a
107 Nm



WS16
Binario Drylin® W,
Binario



DIA
Pistoncino a molla,
con anello



CHAEss
Cerniera estetica, Inox



SLB
Pistoncino a molla,
inox



MDB_MTB
Ingranaggio conico in
plastica stampata ,



AFA
Perno di fissaggio, con
anello

Prodotti correlati



BPHFclip
Sfera portante, Anello
di fissaggio -
montaggio dall'alto



BPLe
Sfera portante a
incastro, Leggero



BPHF
Sfera portante a
incastro con flangia,
Forte



BPHF
Sfera portante, Forte