

Mushroom knob with male thread and high head

BCFHUSS

Hygienic Usit®

- Mushroom knob with a male thread and high head for use with Hygienic Usit® sealing washers®
- The high head makes this mushroom knob ideal for manual lateral movements.
- Fully polished surface with a roughness much lower than Ra0.8µm.
- Material:
Stainless steel 1.4404 (316L)
Mirror polished finish

Advantages

- Regardless of the mounting position of the mushroom knob, dirt and residue from product or cleaning material will not adhere. This guarantees easy cleaning.
- USIT® Hygienic sealing washers are used to seal the screwed connection.
- The stem of the mushroom knob is specially designed to ensure an almost cavity free seal thus meeting hygiene requirements.

Accessory

- RDE sealing washers (see pages 37 à 39)

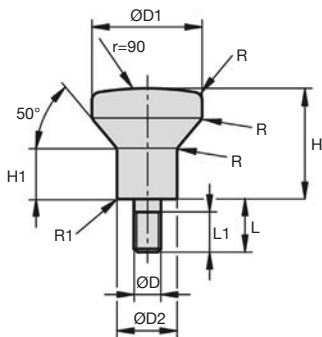

DISCOUNTS

Qty	1+	6+	10+	25+
Disc.	Prix	-5%	-10%	On request

Part N°	ØD	ØD1	ØD2	H	H1	L	T	R	R1	Price each
										1 to 4
BCFH-4/HUSS	M4	20	10,8	19	8	8	7	3	0,45	13,02 €
BCFH-5/HUSS	M5	21	11,8	21	10	10	9	3	0,50	14,10 €
BCFH-6/HUSS	M6	25	14,2	25	12	12	11	3	0,55	15,68 €
BCFH-8/HUSS	M8	33	18,0	33	15	16	15	4	0,60	26,40 €
BCFH-10/HUSS	M10	40	22,3	40	19	20	19	4	0,75	28,18 €

All dimensions in mm

Altri prodotti...



KB_WW
Manicotto chiuso a sfere di precisione, Economica



DOG319
Motoriduttore DC 12V e 24V DC, da 4 a 9 Nm



BABS
Perno autobloccante a sfere inox 630, Inox temprato



PW_PWG1
Vite senza fine di precisione, Inox

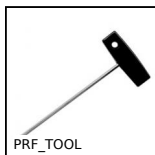

PRF_TOOL
Attrezzi, Chiave di montaggio



EHD08-9
Riduttore coassiale, da 35 a 50 Nm



PSPD40
Manopola a pressione, PVC nero



T5M T10M
Cinghia aperta al metro tipo T, T10 Poliuretano armatura in acciaio



PLM-16A
Magneze, Con foro maschiato



PT820
Pignone di trazione, Serie 820 e 815



PCS_PA6
, 12.7mm (DIN 08B-1)



KSM
Dado cilindrico in acciaio, Acciaio - 1 filetto

Prodotti correlati



RDE-W
Rondella di tenuta Hygienic Usit®, Inox - EPDM bianco



RDE-B
Rondella di tenuta Hygienic Usit®, Stainless steel - EPDM blu



BCTH
Pomello a fungo Hygienic Usit®, Con foro filettato e collare alto