

Locking pin with interlocking safety latch

Steel

AFSE

- Allows easy and quick location of parts or workpieces requiring assembly

- Material:

Galvanized steel

Advantages

- The interlocking safety latch allows components with a large cross sectional area to be secured together
- In addition they absorb any axial movement
- Indexing slots in the safety latch are used to locate the "Closed" and "Open" position

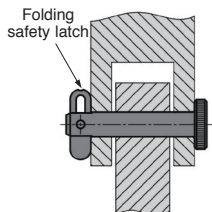

Typical application

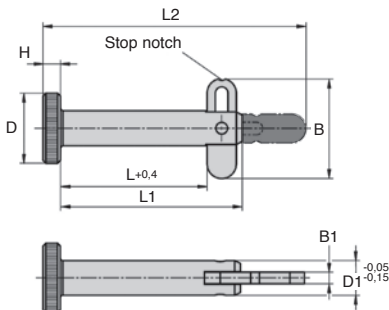

DISCOUNTS

Qty	1+	6+	10+	25+
Disc.	List	-5%	-10%	On request

Part number	ØD	ØD1	L	L1	L2	H	B	B1	Mounting hole H11	Shearing force		Price each 1 to 5
										double section max (kN)	Extraction force (N)	
AFSE6-25	12	6	25	31	45	3	16,9	2	6	12	190	15,42 €
AFSE6-40	12	6	40	46	60	3	16,9	2	6	12	190	15,75 €
AFSE6-50	12	6	50	56	70	3	16,9	2	6	12	190	16,23 €
AFSE8-25	16	8	25	31	46	4	16,9	2	8	21	270	16,23 €
AFSE8-40	16	8	40	46	61	4	16,9	2	8	21	270	16,71 €
AFSE8-50	16	8	50	56	71	4	16,9	2	8	21	270	17,01 €

Dimensions in mm

0 825 88 6000
Service 0,15 € / min
+ prix appel

Altri prodotti...



BUH77
Motoriduttore DC 12V
e 24V DC, da 0.1 a 2
Nm



LRR22
Small dimension latch
with locking system,
Aluminium



MHXred
Manicotto di
riduzione, Esagonale -
acciaio



GARDLL
Bussola portamaschi,
Acciaio o Inox
Acciaio nichelato or
Inox



PSG125
Ingranaggio dritto di
precisione, Acciaio
20NCD2 cementato
temprato



CHN_CHNSS
Catena dritta a maglie
lunghe, Inox



MCLred
Manicotto di
riduzione, Cilindrico -
inox



BTE
Tenditore automatico
universale, Per
applicazioni correnti



NCT
Giunto di
collegamento, Ad
angolo fisso



PCS75K
Pignone a catena
dentatura temprata,
19.05mm (DIN12B-1)



PRF-SCL
Sistema di chiusura
per profili alluminio,
Lock for sliding doors

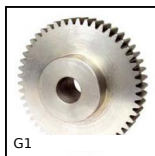

G1
Ingranaggio dritto
acciaio, Acciaio
20NCD2

Prodotti correlati



BAB
Perno autobloccante a
sfere, Inox temprato



BABS
Perno autobloccante a
sfere inox, Inox
temprato



BABT
Perno autobloccante,
Inox temprato



BABreglabile
Perno autobloccante,
Regolabile