

Floor anchor for aluminium profiles

ACLEFS

Right angled floor anchor

- For securing aluminium profiles to a floor

- Material :
Zamak

Advantages

- Suitable for use with PRF aluminium profiles
- Only for use with profiles wider than 40mm

NEW!

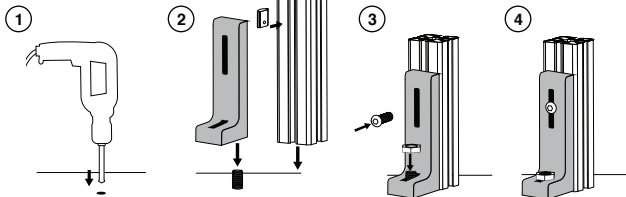
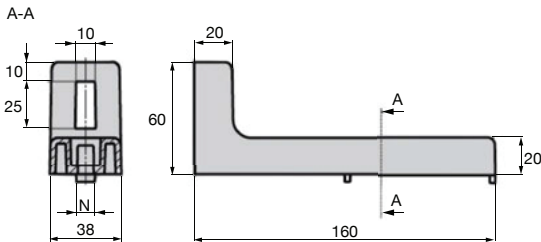

DISCOUNTS

| | | | |
|------------|-----|------------|------|
| Qty | 1+ | 50+ | 100+ |
| Disc. List | -5% | On request | |

| Part number | N | Weight (g) | Prix Uni. 1 à 49 |
|-------------|---|------------|------------------|
| ACL-EFS-160 | 8 | 110 | 10,57 € |

Dimensions in mm



Floor anchor for aluminium profiles

Adjustable height floor anchor

ACLEFS/A

- For securing aluminium profiles
to a floor

Material:

Zamak

Advantages

- Adjustable
- Suitable for use with
PRF aluminium profiles

NEW!

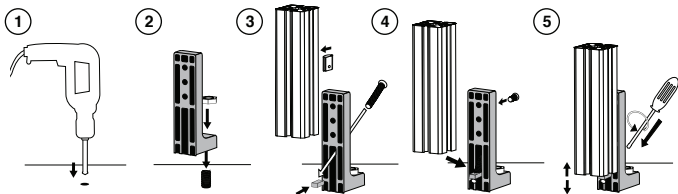
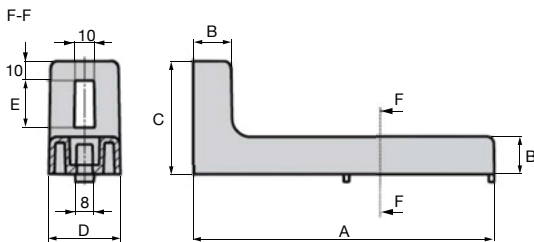

DISCOUNTS

| | | | |
|------------|-----|-----|------------|
| Qty | 1+ | 50+ | 100+ |
| Disc. List | -5% | | On request |

| Part number | Profile size (mm) | A | B | C | D | E | Max height | Weight (g) | Price each 1 to 49 |
|---------------|-------------------|-----|----|----|----|----|------------|------------|--------------------|
| ACL-EFS-120/A | 30 min | 120 | 15 | 45 | 28 | 19 | 52 | 88 | 11,83 € |
| ACL-EFS-160/A | 40 min | 160 | 20 | 60 | 38 | 29 | 72 | 120 | 16,34 € |

Dimensions in mm

Altri prodotti...



BPM_LOK

Pressore a molla con intaglio e puntale a sfera, LONG-LOK - Inox 303



TBD

Tavola di posizionamento a passo inverso manuale, 40kg



PT820

Pignone di trazione, Serie 820 e 815



PTCR

Adjustable furniture foot, square tube



MLY

Grillo con chiodo ad occhiello, Acciaio

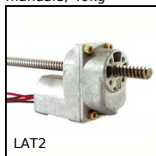

LAT2

Attuatore lineare a motore 2A, 2 ampere



DOMI50

Kit di raccordo, Kit di raccordo XZ



BPLE

Sfera portante a incastro, Leggero



HW_HT

Guida su semi-binari, Ruota

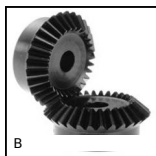

B

Ingranaggio conico - Acciaio 60C40, 1:1

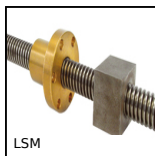

LSM

Vite trapezoidale inox 316L, Inox - 1 filetto

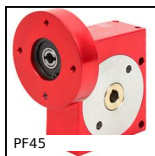

PF45

Riduttore a ruota e vite senza fine, fino a 40 Nm

Prodotti correlati



PRF4545

Profilato alluminio standard, 45 x 45 mm