

Small 6 lobe threaded handle



VB

Black Duroplast blind insert

- **Operating element**
- **Materials:**
Black phenolic Duroplast
Insert: brass or stainless steel

Advantages

- Easy grip
- Temperature resistant
- Good chemical resistance
- Easier to clean than technopolymer
- In machining applications, less likely to retain swarf

Good
resistance



brass or
stainless steel
insert

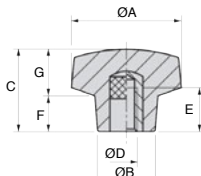

VB20-VB50

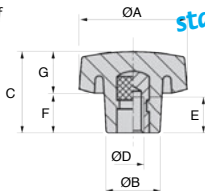

DISCOUNTS VB60-VB70

Qty	1+	10+	20+	50+	100+	200+
Disc.	List	-5%	-10%	-15%	-20%	On request

Part number	ØA	ØB	C	ØD	E	F	G	Weight (g)	Price each 1 to 9
Brass insert									
VB20-M4	20	13	15	M4	9	7	8	5	2,91 €
VB20-M5	20	13	15	M5	9	7	8	5	3,03 €
VB20-M6	20	13	15	M6	9	7	8	5	3,10 €
VB30-M6	30	17	24	M6	9	11	13	15	3,82 €
VB30-M8	30	17	24	M8	15	11	13	17	3,92 €
VB40-M8	40	21	28	M8	15	12	16	34	4,76 €
VB40-M10	40	21	28	M10	16	12	16	36	4,86 €
VB50-M8	50	25	33	M8	15	13	20	54	5,80 €
VB50-M10	50	25	33	M10	16	13	20	56	5,80 €
VB50-M12	50	25	33	M12	18	13	20	58	6,13 €
VB60-M12	60	28	35	M12	18	15	20	70	7,60 €
VB70-M12	70	32	42	M12	18	21	21	95	9,37 €
VB70-M14	70	32	42	M14	20	21	21	100	10,41 €
VB70-M16	70	32	42	M16	20	21	21	102	10,74 €
Stainless steel insert									
VB20-M5/SS	20	13	15	M5	9	7	8	5	5,94 €
VB20-M6/SS	20	13	15	M6	9	7	8	5	6,23 €
VB30-M6/SS	30	17	24	M6	9	11	13	15	8,22 €
VB40-M8/SS	40	21	28	M8	15	12	16	33	9,45 €
VB50-M8/SS	50	25	33	M8	15	13	20	54	11,21 €
VB50-M10/SS	50	25	33	M10	16	13	20	55	16,01 €

Dimensions in mm