

Sealed flange bearing unit for Food Industry

SBFop

With 4 fixing holes

- **Sealed bearing**
- Massive, without retention surface
- Resistant to frequent washing and detergents
- **Materials**
 - 316 stainless steel housing
 - 440 stainless steel bearing
 - Optical and detectable blue hygienic seals
- Complies with EHEDGE hygiene directives

NEW !

open



Application

- For the highly challenging food and beverage industry

Info

- Stainless steel bearings for the food and beverage industry are completely sealed units with an open or closed cover and a rear seal.

Blue foodgrade cover seal

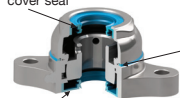

Blue foodgrade back seal



O-ring

DHRGS foodgrade hygienic seal

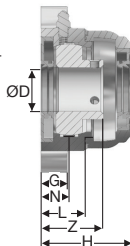
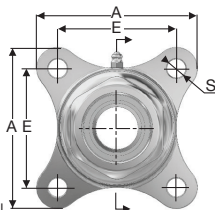

| Type | SBF | SBF | SBF | SBF | SBF | SBF | SBF |
|-------------|-----|-----|-----|-----|-----|-----|-----|
| of load (N) | 204 | 205 | 206 | 207 | 208 | 209 | 210 |

| | | | | | | | |
|--|-------|-------|-------|-------|-------|-------|-------|
| | 15950 | 13000 | 18000 | 18500 | 19100 | 19350 | 19650 |
|--|-------|-------|-------|-------|-------|-------|-------|

| | | | | | | | |
|--|-------|-------|-------|-------|-------|-------|-------|
| | 10250 | 12150 | 17700 | 18500 | 19250 | 19350 | 19620 |
|--|-------|-------|-------|-------|-------|-------|-------|

| | | | | | | | |
|--|------|------|------|------|------|------|------|
| | 3650 | 3350 | 3350 | 3520 | 3790 | 3850 | 3990 |
|--|------|------|------|------|------|------|------|

DISCOUNTS

| Qty | 1+ | 4+ | 8+ |
|-------|------|-----|------------|
| Disc. | List | -5% | On request |

| Part Number | Diameter | | | | | | | | | Price each 1 to 3 |
|-------------|----------|-----|-----|----|------|----|----|----|------|----------------------|
| | ØD | A | E | G | H | L | N | S | Z | |
| SBF204/OP | 20 | 88 | 64 | 15 | 51,9 | 24 | 15 | 12 | 33,0 | 135,74 € |
| SBF205/OP | 25 | 95 | 70 | 15 | 52,4 | 25 | 16 | 12 | 35,5 | 155,14 € |
| SBF206/OP | 30 | 108 | 83 | 15 | 58,7 | 29 | 18 | 12 | 40,0 | 179,38 € |
| SBF207/OP | 35 | 117 | 92 | 17 | 62,4 | 31 | 19 | 14 | 42,5 | 208,46 € |
| SBF208/OP | 40 | 130 | 102 | 17 | 70,7 | 32 | 21 | 16 | 46,0 | 252,10 € |
| SBF209/OP | 45 | 135 | 105 | 18 | 69,2 | 33 | 22 | 16 | 53,7 | 300,58 € |
| SBF210/OP | 50 | 143 | 111 | 20 | 72,7 | 38 | 25 | 16 | 55,0 | 358,75 € |

Dimensions in mm

Sealed flange bearing unit for Food Industry

With 4 fixing holes

SBFCL

- Sealed bearing
- Massive, without retention surface
- Resistant to frequent washing and detergents
- Materials
 - 316 stainless steel housing
 - 440 stainless steel bearing
 - Optical and detectable blue hygienic seals
- Complies with EHEDGE hygiene directives

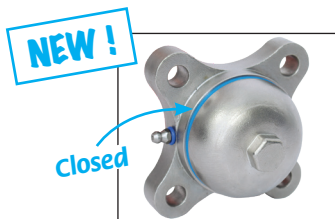

Application

- For the highly challenging food and beverage industry

Info

- Stainless steel bearings for the food and beverage industry are completely sealed units with an open or closed cover and a rear seal.

Blue foodgrade cover seal

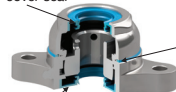

Blue foodgrade back seal



O-ring

DHRGS foodgrade hygienic seal

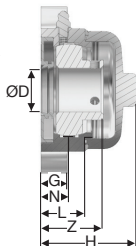
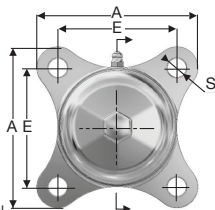

| Type | SBF 204 | SBF 205 | SBF 206 | SBF 207 | SBF 208 | SBF 209 | SBF 210 |
|-------------|---------|---------|---------|---------|---------|---------|---------|
| of load (N) | 204 | 205 | 206 | 207 | 208 | 209 | 210 |

| | | | | | | | |
|---|-------|-------|-------|-------|-------|-------|-------|
| P | 15950 | 13000 | 18000 | 18500 | 19100 | 19350 | 19650 |
|---|-------|-------|-------|-------|-------|-------|-------|

| | | | | | | | |
|---|-------|-------|-------|-------|-------|-------|-------|
| P | 10250 | 12150 | 17700 | 18500 | 19250 | 19350 | 19620 |
|---|-------|-------|-------|-------|-------|-------|-------|

| | | | | | | | |
|---|------|------|------|------|------|------|------|
| P | 3650 | 3350 | 3350 | 3520 | 3790 | 3850 | 3990 |
|---|------|------|------|------|------|------|------|

DISCOUNTS

| Qty | 1+ | 4+ | 8+ |
|------------|-----|-----|------------|
| Disc. List | -5% | -5% | On request |

| Part Number | Diameter | | | | | | | | Price each 1 to 3 | |
|-------------|----------|-----|-----|----|------|----|----|----|-------------------|----------|
| | ØD | A | E | G | H | L | N | S | | Z |
| SBF204/CL | 20 | 88 | 64 | 15 | 54,2 | 24 | 15 | 12 | 33,0 | 126,05 € |
| SBF205/CL | 25 | 95 | 70 | 15 | 54,7 | 25 | 16 | 12 | 35,5 | 140,59 € |
| SBF206/CL | 30 | 108 | 83 | 15 | 61,0 | 29 | 18 | 12 | 40,0 | 174,53 € |
| SBF207/CL | 35 | 117 | 92 | 17 | 64,7 | 31 | 19 | 14 | 42,5 | 198,77 € |
| SBF208/CL | 40 | 130 | 102 | 17 | 70,0 | 32 | 21 | 16 | 46,0 | 237,55 € |
| SBF209/CL | 45 | 135 | 105 | 18 | 71,5 | 33 | 22 | 16 | 53,7 | 286,03 € |
| SBF210/CL | 50 | 143 | 111 | 20 | 71,0 | 38 | 25 | 16 | 55,0 | 353,90 € |

Dimensions in mm

Sealed flange bearing unit for Food Industry

SBFLOP

With 2 fixing holes

- **Sealed bearing**
- Massive, without retention surface
- Resistant to frequent washing and detergents
- Materials
 - 316 stainless steel housing
 - 440 stainless steel bearing
 - Optical and detectable blue hygienic seals
- Complies with EHEDGE hygiene directives

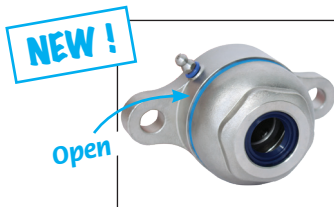

Application

- For the highly challenging food and beverage industry

Info

- Stainless steel bearings for the food and beverage industry are completely sealed units with an open or closed cover and a rear seal

Blue foodgrade cover seal

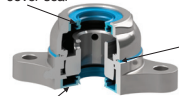

Blue foodgrade back seal



O-ring

DHRGS foodgrade hygienic seals

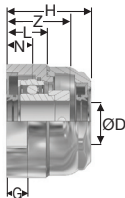
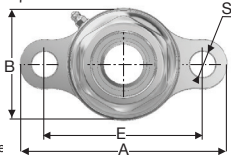

| Type | SBFL 204 | SBFL 205 | SBFL 206 | SBFL 207 | SBFL 208 | SBFL 209 | SBFL 210 |
|-------------|----------|----------|----------|----------|----------|----------|----------|
| of load (N) | 204 | 205 | 206 | 207 | 208 | 209 | 210 |

| | | | | | | | |
|--|-------|-------|-------|-------|-------|-------|-------|
| | 11750 | 11375 | 16450 | 16900 | 17350 | 17600 | 17950 |
|--|-------|-------|-------|-------|-------|-------|-------|

| | | | | | | | |
|--|-------|-------|-------|-------|-------|-------|-------|
| | 11000 | 13850 | 13350 | 13950 | 14050 | 14300 | 14550 |
|--|-------|-------|-------|-------|-------|-------|-------|

| | | | | | | | |
|--|------|------|-------|-------|-------|-------|-------|
| | 8500 | 1100 | 14200 | 14900 | 15150 | 15350 | 15650 |
|--|------|------|-------|-------|-------|-------|-------|

DISCOUNTS

| Qty | 1+ | 4+ | 8+ |
|-------|------|-----|------------|
| Disc. | List | -5% | On request |

| Part Number | Diameter | | | | | | | | | | Price each 1 to 3 |
|-------------|----------|-----|-----|-----|----|------|----|----|----|------|----------------------|
| | ØD | A | B | E | G | H | L | N | S | Z | |
| SBFL204/OP | 20 | 115 | 65 | 90 | 11 | 51,9 | 24 | 15 | 12 | 33,0 | 130,90 € |
| SBFL205/OP | 25 | 130 | 70 | 99 | 13 | 52,4 | 25 | 16 | 16 | 35,5 | 145,44 € |
| SBFL206/OP | 30 | 148 | 80 | 117 | 13 | 58,7 | 29 | 18 | 16 | 40,0 | 164,83 € |
| SBFL207/OP | 35 | 161 | 90 | 130 | 15 | 62,4 | 31 | 19 | 16 | 42,5 | 193,92 € |
| SBFL208/OP | 40 | 175 | 100 | 144 | 15 | 70,7 | 32 | 21 | 16 | 46,0 | 237,55 € |
| SBFL209/OP | 45 | 188 | 110 | 148 | 16 | 69,2 | 33 | 22 | 19 | 53,7 | 276,34 € |
| SBFL210/OP | 50 | 197 | 120 | 157 | 16 | 72,7 | 38 | 22 | 19 | 55,0 | 324,82 € |

Dimensions in mm

Sealed flange bearing unit for Food Industry

With 2 fixing holes

SBFLCL

- **Sealed bearing**
- Massive, without retention surface
- Resistant to frequent washing and detergents
- Materials
 - 316 stainless steel housing
 - 440 stainless steel bearing
 - Optical and detectable blue hygienic seals
- Complies with EHEDGE hygiene directives



Application

- For the highly challenging food and beverage industry

Info

- Stainless steel bearings for the food and beverage industry are completely sealed units with an open or closed cover and a rear seal

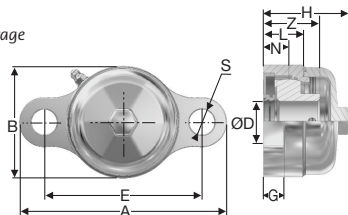
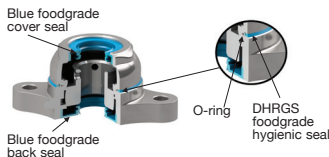

| Type | SBFL 204 | SBFL 205 | SBFL 206 | SBFL 207 | SBFL 208 | SBFL 209 | SBFL 210 |
|-------------|----------|----------|----------|----------|----------|----------|----------|
| of load (N) | 204 | 205 | 206 | 207 | 208 | 209 | 210 |

| | | | | | | | |
|--|-------|-------|-------|-------|-------|-------|-------|
| | 11750 | 11375 | 16450 | 16900 | 17350 | 17600 | 17950 |
|--|-------|-------|-------|-------|-------|-------|-------|

| | | | | | | | |
|--|-------|-------|-------|-------|-------|-------|-------|
| | 11000 | 13850 | 13350 | 13950 | 14050 | 14300 | 14550 |
|--|-------|-------|-------|-------|-------|-------|-------|

| | | | | | | | |
|--|------|------|-------|-------|-------|-------|-------|
| | 8500 | 1100 | 14200 | 14900 | 15150 | 15350 | 15650 |
|--|------|------|-------|-------|-------|-------|-------|

DISCOUNTS

| Qty | 1+ | 4+ | 8+ |
|------------|-----|------------|----|
| Disc. List | -5% | On request | |

| Part Number | Diameter | | | | | | | | | | Price each 1 to 3 |
|-------------|----------|-----|-----|-----|----|------|----|----|----|------|-------------------|
| | ØD | A | B | E | G | H | L | N | S | Z | |
| SBFL204/CL | 20 | 115 | 65 | 90 | 11 | 54,2 | 24 | 15 | 12 | 33,0 | 121,20 € |
| SBFL205/CL | 25 | 130 | 70 | 99 | 13 | 54,7 | 25 | 16 | 16 | 35,5 | 130,90 € |
| SBFL206/CL | 30 | 148 | 80 | 117 | 13 | 61,0 | 29 | 18 | 16 | 40,0 | 155,14 € |
| SBFL207/CL | 35 | 161 | 90 | 130 | 15 | 64,7 | 31 | 19 | 16 | 42,5 | 184,22 € |
| SBFL208/CL | 40 | 175 | 100 | 144 | 15 | 70,0 | 32 | 21 | 16 | 46,0 | 223,01 € |
| SBFL209/CL | 45 | 188 | 110 | 148 | 16 | 71,5 | 33 | 22 | 19 | 53,7 | 261,79 € |
| SBFL210/CL | 50 | 197 | 120 | 157 | 16 | 71,0 | 38 | 22 | 19 | 55,0 | 315,12 € |

Dimensions in mm

Sealed flange bearing unit for Food Industry

SBFB_{OP}

With 3 offset fixing points

- **Sealed bearing**
- Massive, without retention surface
- Resistant to frequent washing and detergents
- Materials
 - 316 stainless steel housing
 - 440 stainless steel bearing
 - Optical and detectable blue hygienic seals
- Complies with EHEDGE hygiene directives

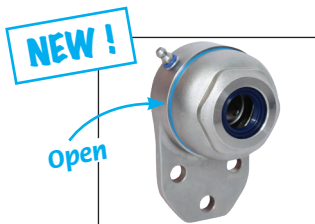

Application

- For the highly challenging food and beverage industry

Info

- Stainless steel bearings for the food and beverage industry are completely sealed units with an open or closed cover and a rear seal.

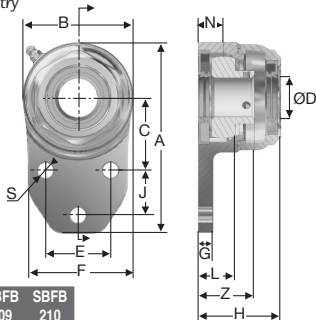
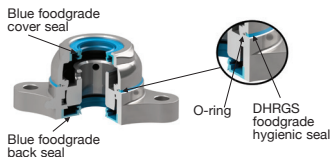

| Type of load (N) | SBFB 204 | SBFB 205 | SBFB 206 | SBFB 207 | SBFB 208 | SBFB 209 | SBFB 210 |
|------------------|----------|----------|----------|----------|----------|----------|----------|
|------------------|----------|----------|----------|----------|----------|----------|----------|

| | | | | | | | |
|--|---|---|---|------|-------|-------|-------|
| | - | - | - | 7200 | 9100 | 12200 | 12900 |
| | - | - | - | 9200 | 11100 | 11800 | 11900 |
| | - | - | - | 2600 | 2800 | 2900 | 3100 |

DISCOUNTS

| Qty | 1+ | 4+ | 8+ |
|-------|------|-----|------------|
| Disc. | List | -5% | On request |

| Part Number | Diameter | | | | | | | | | | | | | Price each 1 to 3 |
|-------------|----------|-----|-----|------|------|-------|------|------|------|----|----|----|------|----------------------|
| | ØD | A | B | C | E | F | G | H | J | L | N | S | Z | |
| SBFB204/OP | 20 | 108 | 65 | 43,3 | 38,1 | 60,3 | 8,0 | 51,9 | 22,0 | 24 | 15 | 10 | 33,0 | 140,59 € |
| SBFB205/OP | 25 | 121 | 70 | 46,0 | 41,3 | 63,5 | 9,5 | 52,9 | 28,5 | 25 | 16 | 10 | 35,5 | 164,83 € |
| SBFB206/OP | 30 | 137 | 80 | 52,4 | 47,6 | 70,0 | 9,5 | 58,7 | 31,7 | 29 | 18 | 10 | 40,0 | 184,22 € |
| SBFB207/OP | 35 | 156 | 90 | 60,3 | 50,8 | 83,0 | 12,7 | 62,4 | 31,7 | 31 | 19 | 13 | 42,5 | 227,86 € |
| SBFB208/OP | 40 | 164 | 100 | 60,3 | 50,0 | 78,0 | 15,9 | 70,7 | 41,3 | 32 | 21 | 12 | 46,0 | 271,49 € |
| SBFB209/OP | 45 | 176 | 110 | 65,0 | 54,0 | 80,0 | 18,3 | 69,2 | 42,9 | 33 | 22 | 12 | 53,7 | 324,82 € |
| SBFB210/OP | 50 | 190 | 120 | 74,6 | 70,0 | 102,0 | 12,7 | 72,5 | 41,3 | 38 | 22 | 13 | 55,0 | 373,30 € |

Dimensions in mm

Sealed flange bearing unit for Food Industry

With 3 offset fixing points

SBFBCL

- Sealed bearing
- Massive, without retention surface
- Resistant to frequent washing and detergents
- Materials
 - B316 stainless steel housing
 - 440 stainless steel bearing
 - Optical and detectable blue hygienic seals
- Complies with EHEDGE hygiene directives

Application

- For the highly challenging food and beverage industry

Info

- Stainless steel bearings for the food and beverage industry are completely sealed units with an open or closed cover and a rear seal.

Blue foodgrade cover seal

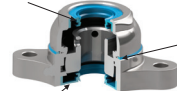

Blue foodgrade back seal

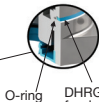

O-ring
DHRGS foodgrade hygienic seal

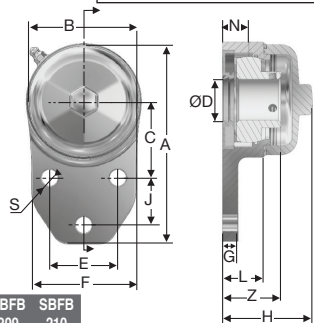

| Type of load (N) | SBFB 204 | SBFB 205 | SBFB 206 | SBFB 207 | SBFB 208 | SBFB 209 | SBFB 210 |
|------------------|----------|----------|----------|----------|----------|----------|----------|
|------------------|----------|----------|----------|----------|----------|----------|----------|

| | | | | | | | |
|--|---|---|---|------|------|-------|-------|
| | - | - | - | 7200 | 9100 | 12200 | 12900 |
|--|---|---|---|------|------|-------|-------|

| | | | | | | | |
|--|---|---|---|------|-------|-------|-------|
| | - | - | - | 9200 | 11100 | 11800 | 11900 |
|--|---|---|---|------|-------|-------|-------|

| | | | | | | | |
|--|---|---|---|------|------|------|------|
| | - | - | - | 2600 | 2800 | 2900 | 3100 |
|--|---|---|---|------|------|------|------|

DISCOUNTS

| Qty | 1+ | 4+ | 8+ |
|-------|------|-----|------------|
| Disc. | List | -5% | On request |

| Part Number | Diameter | | | | | | | | | | | | | Price each 1 to 3 |
|-------------|----------|-----|-----|------|------|-------|------|------|------|----|----|----|------|-------------------|
| | ØD | A | B | C | E | F | G | H | J | L | N | S | Z | |
| SBFB204/CL | 20 | 108 | 65 | 43,3 | 38,1 | 60,3 | 8,0 | 54,2 | 22,0 | 24 | 15 | 10 | 33,0 | 130,90 € |
| SBFB205/CL | 25 | 121 | 70 | 46,0 | 41,3 | 63,5 | 9,5 | 54,7 | 28,5 | 25 | 16 | 10 | 35,5 | 150,29 € |
| SBFB206/CL | 30 | 137 | 80 | 52,4 | 47,6 | 70,0 | 9,5 | 61,0 | 31,7 | 29 | 18 | 10 | 40,0 | 179,38 € |
| SBFB207/CL | 35 | 156 | 90 | 60,3 | 50,8 | 83,0 | 12,7 | 64,7 | 31,7 | 31 | 19 | 13 | 42,5 | 218,16 € |
| SBFB208/CL | 40 | 164 | 100 | 60,3 | 50,0 | 78,0 | 15,9 | 70,0 | 41,3 | 32 | 21 | 12 | 46,0 | 256,94 € |
| SBFB209/CL | 45 | 176 | 110 | 65,0 | 54,0 | 80,0 | 18,3 | 71,5 | 42,9 | 33 | 22 | 12 | 53,7 | 310,27 € |
| SBFB210/CL | 50 | 190 | 120 | 74,6 | 70,0 | 102,0 | 12,7 | 71,0 | 41,3 | 38 | 22 | 13 | 55,0 | 363,60 € |

Dimensions in mm