



Spur gear coaxial gearbox

Torque up to 20Nm

NT63
NH63

- Ratios from 1:1 to 120:1 (other ratios available on request)
- Output backlash: N/A
- Max. input speed: 3000 rpm
- Materials:
 - casing: anodised aluminium
 - input & output: unhardened steel
- Weight: 0.64 kg

Options

- Can be adapted to suit your motor
- Ask for the ratio you require
- Also see NT61, NH61 and NT62, NH62
- keyway conforms to DIN 6885

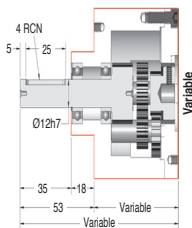

NH63

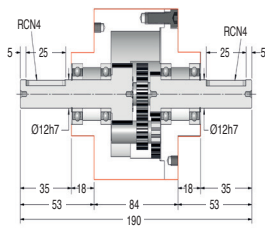

NT63

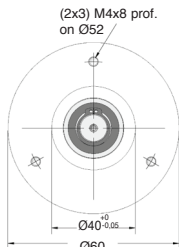

Output face

OUTPUT TORQUE (In Nm, values given as a guide only)

Ratios	30:1	36:1	40:1	48:1	54:1	81:1	120:1
3000	8,0	9,0	9,0	9,0	9,0	10,0	10,0
2000	8,5	9,0	9,0	9,0	9,0	10,0	10,0
1000	9,0	10,0	10,0	10,0	10,0	10,0	10,0
500	10,0	11,0	11,0	11,0	11,0	11,0	11,0
200	12,0	12,0	12,0	12,0	12,0	12,0	12,0
100	14,0	14,0	14,0	14,0	14,0	14,0	14,0
50	16,0	17,0	17,0	17,0	17,0	17,0	17,0
20	19,0	20,0	20,0	20,0	20,0	20,0	20,0

Large choice of reduction ratios!
Up to 120:1

DISCOUNTS

Qty.	1+	2+	4+	6+
Disc.	List	-15%	-20%	On request

Part number	Ratios	Max. input speed (rpm)	Max. output speed (rpm)	Efficiency at 1000 rpm	Module	Direction of input/output rotation	Price each
NT63-30 NH63-30	30:1	3000	100	80%	Opposite	849,04 €	On request
NT63-36 NH63-36	36:1	3000	83	80%	Opposite	849,04 €	
NT63-40 NH63-40	40:1	3000	75	80%	Opposite	849,04 €	
NT63-48 NH63-48	48:1	3000	62	80%	Opposite	849,04 €	
NT63-54 NH63-54	54:1	3000	55	80%	Opposite	849,04 €	
NT63-81 NH63-81	81:1	3000	37	80%	Opposite	849,04 €	
NT63-120 NH63-120	120:1	3000	25	80%	Same	849,04 €	
NT63-SP NH63-SP	1:1 - 120:1	Special ratios from 1:1 to 120:1				947,21 €	

Dimensions in mm