



# Spur gear coaxial gearbox

**Torque up to 85Nm**

**NT122  
NH122**

- Ratios from 1:1 to 27:1 (other ratios available on request)
- Output backlash: N/A
- Max. input speed: 3000 rpm
- Materials:
  - casing: anodised aluminium
  - input & output: unhardened steel
- Weight: 2.6 kg



## Options

- Can be adapted to suit your motor
- Ask for the ratio you require
- Also see NT121, NH121
- keyway conforms to DIN 6885

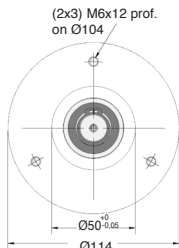
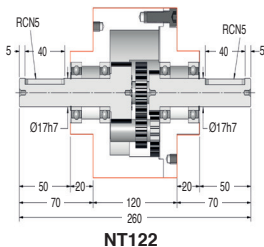
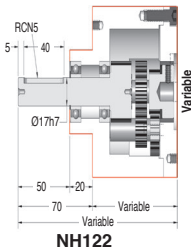

Output face

## OUTPUT TORQUE (In Nm, values given as a guide only)

Ratios	10:1	12:1	15:1	18:1	24:1	8:1
3000	32	32	32	32	32	32
2000	36	36	36	36	36	36
1000	42	42	42	42	42	42
500	49	49	49	49	49	49
200	54	54	54	54	54	54
100	61	61	61	61	61	61
50	73	73	73	73	73	73
20	85	85	85	85	85	85

**Large choice of  
reduction ratios!  
Up to 27:1**

## DISCOUNTS

Qty.	1+	2+	4+	6+
Disc.	List	-15%	-20%	On request

Part number	Ratios	Max. input speed (rpm)	Max. output speed (rpm)	Efficiency at 1000 rpm	Module	Direction of input/output rotation	Price each
NT122-10 NH122-10	10:1	3000	300	88%	Opposite	1 097,17 €	<b>On request</b>
NT122-12 NH122-12	12:1	3000	250	88%	Opposite	1 097,17 €	
NT122-15 NH122-15	15:1	3000	200	88%	Opposite	1 097,17 €	
NT122-18 NH122-18	18:1	3000	166	88%	Opposite	1 097,17 €	
NT122-24 NH122-24	24:1	3000	125	88%	Opposite	1 097,17 €	
NT122-27 NH122-27	27:1	3000	111	88%	Opposite	1 097,17 €	
NT122-SP NH122-SP	1:1 - 27:1	<b>Special ratios from 1:1 to 27:1</b>				1 164,96 €	

Dimensions in mm