

Spur gear coaxial gearbox



NT121 NH121

Torque up to 68Nm

- Ratios from 1:1 to 9:1 (other ratios available on request)
- Output backlash: N/A
- Max. input speed: 3000 rpm
- Materials:
 - casing: anodised aluminium
 - input & output: unhardened steel
- Weight: 2.3 kg

Options

- Can be adapted to suit your motor
- Ask for the ratio you require
- Also see **NT122, NH122**
- keyway conforms to DIN 6885

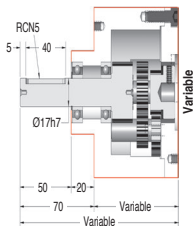
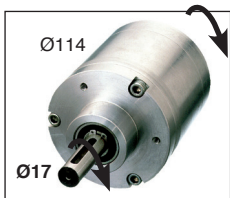

NH121

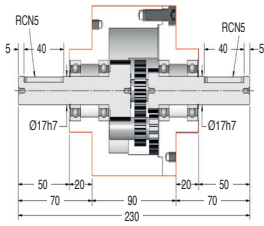

NT121

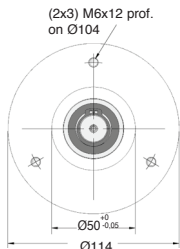

Output face

OUTPUT TORQUE (In Nm, values given as a guide only)

Ratios	2:1	3:1	4:1	5:1	6:1	8:1	9:1
3000	20,0	20,0	21,1	22,2	23,5	29,7	26,0
2000	23,0	23,6	24,7	26,0	27,4	28,6	30,0
1000	27,1	27,5	28,6	29,7	31,0	32,5	34,0
INPUT SPEED (rpm)	500	31,5	32,0	33,3	34,8	36,4	38,0
	200	35,0	35,5	37,2	38,0	40,8	42,8
	100	40,0	41,0	41,8	42,7	43,6	47,0
	50	47,2	48,0	50,2	52,5	55,0	61,1
	20	53,0	55,0	57,0	60,0	62,0	65,0

Large choice of reduction ratios!
Up to 27:1

DISCOUNTS

Qty.	1+	2+	4+	6+
Disc.	List	-15%	-20%	On request

Part number	Ratios	Max. input speed (rpm)	Max. output speed (rpm)	Efficiency at 1000 rpm	Module	Direction of input/output rotation	Price each
NT121-2	NH121-2	2:1	3000	1500	92%	Same	916,71 €
NT121-3	NH121-3	3:1	3000	1000	92%	Same	916,71 €
NT121-4	NH121-4	4:1	3000	750	92%	Same	916,71 €
NT121-5	NH121-5	5:1	3000	600	92%	Same	916,71 €
NT121-6	NH121-6	6:1	3000	500	92%	Same	916,71 €
NT121-8	NH121-8	8:1	3000	375	92%	Same	916,71 €
NT121-9	NH121-9	9:1	3000	333	92%	Same	916,71 €
NT121-SP	NH121-SP	1:1 - 9:1	Special ratios from 1:1 to 9:1				1 020,75 €

On request

Dimensions in mm