

- **Chiusura di catena**
- Avvitare per fissare
- Materiale:  
Inox 316L  
Asta/dado X2CrNi

### Info.

- CMU: Carico massimo utile  
Il carico di rottura si ottiene moltiplicando CMA per il coefficiente di sicurezza 5.

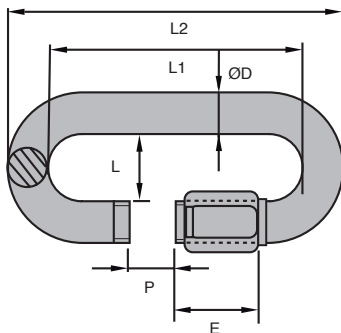

### SCONTI PER QUANTITÀ

Qtà	1+	20+	40+	60+	80+	100+
Sc.	Prezzo	-5%	-10%	-15%	-20%	Su richiesta

Codice	ØD	L2	L1	L	P	E	CMU (kg)	Peso per 100 pezzi (kg)	Stock*	Prezzo unit. da 1 a 19
MRA1-04/SS	4	40,0	32,0	11,0	6,0	12,0	280	1,200	✓	8,64 €
MRA1-05/SS	5	48,0	38,0	12,0	7,0	16,0	450	2,100	✓	9,65 €
MRA1-06/SS	6	57,0	45,0	14,0	9,0	19,0	650	3,540	✓	12,32 €
MRA1-07/SS	7	66,0	52,0	16,0	8,0	21,0	900	5,230	-	16,76 €
MRA1-08/SS	8	73,0	57,0	17,0	12,0	24,0	1100	7,900	-	16,76 €
MRA1-09/SS	9	80,0	62,0	19,0	11,0	26,0	1400	10,500	-	25,33 €
MRA1-10/SS	10	89,0	69,0	20,0	13,0	29,0	1800	14,050	-	30,66 €
MRA1-12/SS	12	105,0	81,0	23,0	16,0	34,0	2500	23,200	✓	48,83 €

\*Nei limiti delle disponibilità - Dimensioni in mm