

# Cylindrical ballscrew nut



## GBMz

## For KGS ballscrew

- Nut for ballscrew
- Multiple starts
- Axial backlash: 0.2mm
- Material:  
16 MnCr5 or 100Cr6

### Accessory

- See KGS ballscrew (the pitch and the diameter must be identical to those of the nut)

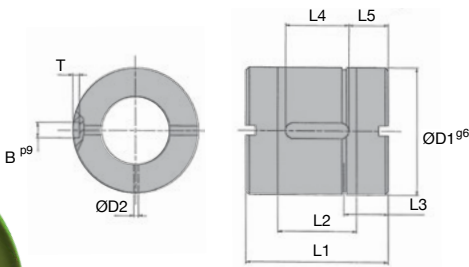
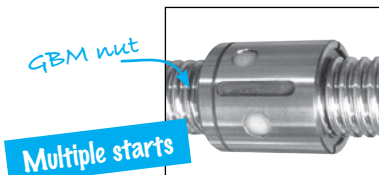

### DISCOUNTS

Qty	1+	2+	6+	11+
Disc.	List	-7%	-13%	On request

Part number	ØD1g6	ØD2	L1	L2	L3	L4	L5	BxT
GBM-Z-2020-RH	35	1,5	30	14	11,50	12	9	5x3
GBM-Z-2050-RH	35	1,5	56	40	14	20	18	5x2
GBM-Z-3220-RH	53	1,5	55	35	16	20	17,5	6x4
GBM-Z-3240-RH	53	1,5	50	30	16	25	12,5	6x4
GBM-Z-5020-RH	85	1,5	73,50	50	16,75	30	22	6x2,5

Part number	For ballscrew		Movement		Load		Weight (kg)	Price each
	Ø	per rev (mm)	dynamic C (kN)	static Co (kN)				
GBM-Z-2020-RH	20	20	9,00	19,10	0,15	439,05 €		
GBM-Z-2050-RH	20	50	7,90	19,00	0,30	479,95 €		
GBM-Z-3220-RH	32	20	19,50	65,00	0,50	587,04 €		
GBM-Z-3240-RH	32	40	11,50	33,50	0,45	590,09 €		
GBM-Z-5020-RH	50	20	61,70	178,40	1,40	1 044,60 €		

Dimensions in mm