

- Threaded plate for securing a component using a screw

- Material:
Steel sheet

Info

- Sold in packs of 100

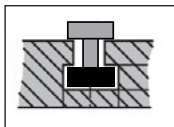

Typical application
in a T slot

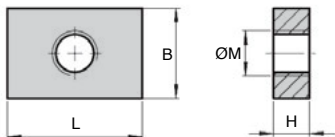
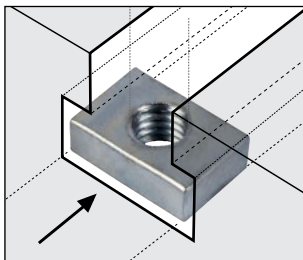

DISCOUNTS

No. packets	1+	5+	10+	20+
Discounts	List	-5%	-10%	On request

Part number	L	B	H	ØM	Qty per packet	Price each 1 to 4
ERT15-10-4-M5/L	15	10	4	M5	100	28,35 €
ERT15-10-4-M6/L	15	10	4	M6	100	28,35 €
ERT15-10-5-M6/L	15	10	5	M6	100	28,35 €
ERT19-16-4-M4/L	19	16	4	M4	100	31,49 €
ERT19-16-4-M5/L	19	16	4	M5	100	31,49 €
ERT19-16-4-M6/L	19	16	4	M6	100	31,49 €
ERT19-16-4-M8/L	19	16	4	M8	100	31,49 €
ERT19-19-4-M5/L	19	19	4	M5	100	31,49 €
ERT19-19-4-M6/L	19	19	4	M6	100	31,49 €
ERT19-19-4-M8/L	19	19	4	M8	100	31,49 €
ERT20-13-5-M6/L	20	13	5	M6	100	31,49 €
ERT20-13-5-M8/L	20	13	5	M8	100	31,49 €
ERT20-20-4-M4/L	20	20	4	M4	100	34,63 €
ERT20-20-6-M5/L	20	20	6	M5	100	34,63 €
ERT20-20-6-M6/L	20	20	6	M6	100	34,63 €
ERT20-20-6-M8/L	20	20	6	M8	100	34,63 €
ERT25-12-5-M6/L	25	12	5	M6	100	31,49 €

Dimensions in mm