

Ventose 1,5 soffiatti

Per superfici irregolari

DCA

- Materiale:
Nitrile (NBR)
- Silicone (SI)
- Gomma naturale (NR)

Applicazione

- Per presa di pezzi a superficie irregolare

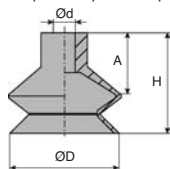

da DCA05 a DCA16

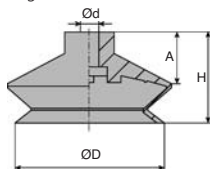

da DCA20 a DCA43



SCONTI PER QUANTITÀ

Qtà	1+	50+	100+	150+	200+
Sc.	Prezzo -5% -10% -15%				Su richiesta

Riferimenti	ØD	H	Ød	A	Inserito corrispondente	Prezzo unit. da 1 a 49
Nitrile						
DCA05-NBR	5,5	11,1	4	8	TM5M5	3,86 €
DCA11-NBR	11,0	16,0	4	9	CTM10M5	3,55 €
DCA14-NBR	14,0	16,0	4	9		3,71 €
DCA16-NBR	16,0	19,0	4	9		3,71 €
DCA20-NBR	20,0	16,0	4	9		3,71 €
DCA22-NBR	22,0	19,0	4	9		3,86 €
DCA25-NBR	25,0	23,0	4	9		4,04 €
DCA33-NBR	33,0	27,5	8	13	SCR30M6	4,18 €
DCA43-NBR	43,0	28,0	8	13		4,44 €
Silicone						
DCA05-SI	5,5	11,1	4	8	TM5M5	4,69 €
DCA11-SI	11,0	16,0	4	9	CTM10M5	4,53 €
DCA14-SI	14,0	16,0	4	9		4,53 €
DCA16-SI	16,0	19,0	4	9		4,53 €
DCA20-SI	20,0	16,0	4	9		4,53 €
DCA22-SI	22,0	19,0	4	9		4,53 €
DCA25-SI	25,0	23,0	4	9		4,69 €
DCA33-SI	33,0	27,5	8	13	SCR30M6	5,17 €
DCA43-SI	43,0	28,0	8	13		5,25 €
Gomma naturale						
DCA05-NR	5,5	11,1	4	8	TM5M5	3,86 €
DCA11-NR	11,0	16,0	4	9	CTM10M5	3,55 €
DCA14-NR	14,0	16,0	4	9		3,71 €
DCA16-NR	16,0	19,0	4	9		3,71 €
DCA20-NR	20,0	16,0	4	9		3,71 €
DCA22-NR	22,0	19,0	4	9		3,86 €
DCA25-NR	25,0	23,0	4	9		4,04 €
DCA33-NR	33,0	27,5	8	13	SCR30M6	4,18 €
DCA43-NR	43,0	28,0	8	13		4,44 €