

New

Worm and wheel gearbox

Integrated torque limiter up to 138 Nm CHML63

- **Protected against overload**
- Ratios from 20:1 to 100:1
- Torque limit can be set anywhere up to the maximum value
- Materials:
 - Casing: aluminium
 - Worm: treated steel
 - Wheel: bronze (cast iron hub)
- Lubrication: synthetic oil ISO VG320

Accessory

- See **CHM63**

Info

- Dimensions are the same as the **CHM** range except for the mounting flanges which may be different.



With integrated torque limiter

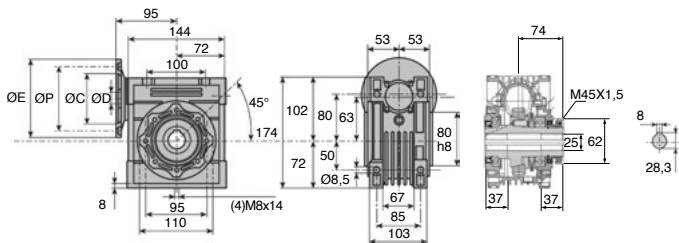

OUTPUT TORQUE (IN Nm, VALUES GIVEN AS A GUIDE ONLY)

Ratio	20:1	25:1	30:1	40:1	50:1	60:1	100:1
Input speed (rpm)	2800	99	91	119	107	99	94
1400	134	129	159	144	134	129	117
900	147	136	174	159	144	137	123
500	177	163	198	184	172	159	127

DISCOUNTS

Qty	1+	6+	20+	40+
Disc.	List -15%	-20%	On request	

Part number	Reduction		Mounting				Self locking		Price each
	ratio	flange	ØD	ØC	ØP	ØE	output		
CHML63-20-90B5	20:1	90B5	24	130	165	200	No	413,05 €	
CHML63-25-90B5	25:1	90B5	24	130	165	200	No	413,05 €	
CHML63-30-90B5	30:1	90B5	24	130	165	200	No	413,05 €	
CHML63-40-80B5	40:1	80B5	19	130	165	200	No	413,05 €	
CHML63-50-80B5	50:1	80B5	19	130	165	200	Not defined	413,05 €	
CHML63-60-80B5	60:1	80B5	19	130	165	200	Not defined	413,05 €	
CHML63-100-71B5	100:1	71B5	14	110	130	160	Yes	413,05 €	

Dimensions in mm