

Boxed set of self tapping inserts

New

BOXINS300

For hard materials

- Selection of self tapping inserts with fine external thread

Assembly

- Refer to INS300

Applications

- For use in aluminium or other non-ferrous metals, thermoplastics or hardwoods

297 pieces

NEW!



Quantity	ØD	L	Ød
30	M5x0,5	6	M3
50	M6,5x0,75	8	M4
20	M8x1	8	M5
40	M8x1	10	M5
20	M9x1	8	M6
20	M9x1	12	M6
40	M10x1,5	14	M6
20	M12x1,5	12	M8
30	M12x1,5	15	M8
20	M14x1,5	18	M10
5	M16x1,5	22	M12
2	M20x1,5	25	M10

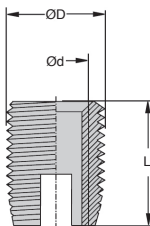

DISCOUNTS

Qty	1+	2+	5+
Disc.	List	-5%	On request

Part number	Material	Quantity per box	Price each
BOX-INS300	Yellow zinc plated hardened steel	297	305,37 €