

Knurled knob, male

BMM Technopolymer, steel or stainless steel stud

- Small fixing knob

- Materials:

Black polyamide, matt surface finish
Threaded stud: chromed steel
or stainless steel

Info

- Can be used with **BMF** female knurled knobs to make a manual bolted assembly

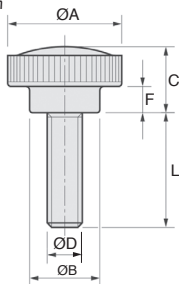

DISCOUNTS

Qty	1+	10+	20+	50+	100+	200+
Disc.	Net	-5%	-10%	-15%	-20%	On request

Part N°		Weight							Price each 1 to 9	
Steel	Stainless steel	ØA	ØB	C	ØD	L	F	(g)	Acier	Inox
BMM15-M4-10		15	11	14	M4	10	7	4	1,18 €	
BMM15-M4-15		15	11	14	M4	15	7	4	1,26 €	
BMM15-M5-10		15	11	14	M5	10	7	4	1,22 €	
BMM22-M4-10		22	15	14	M4	10	6	6	1,26 €	
BMM22-M4-25		22	15	14	M4	25	6	6	1,34 €	
BMM22-M5-10	BMM22-M5-10/SS	22	15	14	M5	10	6	7	1,26 €	3,31 €
BMM22-M5-15		22	15	14	M5	15	6	7	1,26 €	
BMM22-M6-10		22	15	14	M6	10	6	8	1,34 €	
BMM22-M6-20		22	15	14	M6	20	6	9	1,34 €	
BMM22-M6-30		22	15	14	M6	30	6	11	1,43 €	
BMM22-M6-40		22	15	14	M6	40	6	13	1,47 €	
BMM26-M5-10		26	16	15	M5	10	6	9	1,47 €	
BMM26-M5-25		26	16	15	M5	25	6	11	1,47 €	
BMM26-M6-10		26	16	15	M6	10	6	10	1,47 €	
BMM26-M6-20	BMM26-M6-20/SS	26	16	15	M6	20	6	12	1,47 €	3,43 €
BMM26-M6-40		26	16	15	M6	40	6	15	1,55 €	
BMM26-M8-25		26	16	15	M8	25	6	17	1,63 €	
BMM32-M6-20		32	19	18	M6	20	8	14	1,63 €	
BMM32-M6-40		32	19	18	M6	40	8	18	1,71 €	
BMM32-M8-15		32	19	18	M8	15	8	19	1,79 €	
BMM32-M8-40		32	19	18	M8	40	8	27	1,92 €	

All dimensions in mm