

Locking pin with interlocking safety latch

Steel

AFSE

- Allows easy and quick location of parts or workpieces requiring assembly

- Material:

Galvanized steel

Advantages

- The interlocking safety latch allows components with a large cross sectional area to be secured together
- In addition they absorb any axial movement
- Indexing slots in the safety latch are used to locate the "Closed" and "Open" position

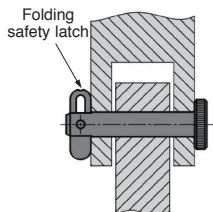

Typical application

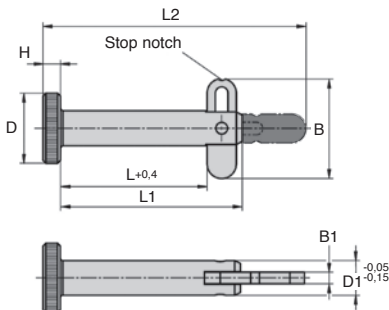

DISCOUNTS

Qty	1+	6+	10+	25+
Disc.	List	-5%	-10%	On request

Part number	ØD	ØD1	L	L1	L2	H	B	B1	Mounting hole H11	Shearing force		Price each 1 to 5
										double section max (kN)	Extraction force (N)	
AFSE6-25	12	6	25	31	45	3	16,9	2	6	12	190	15,42 €
AFSE6-40	12	6	40	46	60	3	16,9	2	6	12	190	15,75 €
AFSE6-50	12	6	50	56	70	3	16,9	2	6	12	190	16,23 €
AFSE8-25	16	8	25	31	46	4	16,9	2	8	21	270	16,23 €
AFSE8-40	16	8	40	46	61	4	16,9	2	8	21	270	16,71 €
AFSE8-50	16	8	50	56	71	4	16,9	2	8	21	270	17,01 €

Dimensions in mm

0 825 88 6000
Service 0,15 € / min
+ prix appel

cial2@hpceurope.com

HPC

SUPPLEMENT 2019

173