

# Drive and idler sprocket

## Common technical specification

### Assembly dimensions

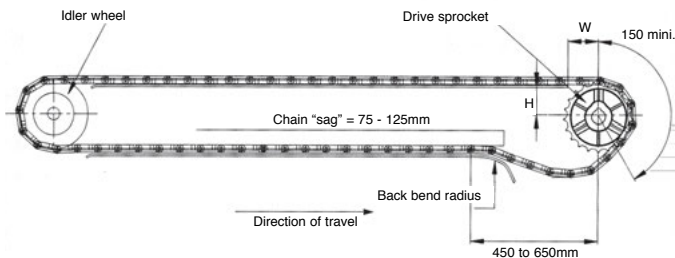

$$H = \left( \frac{DP}{2} + F \right)_{-0}^{+1}$$

Chain part number	F	W
CAP805/SS	3,90	38
CAP815/SS	3,90	38
CAP820	3,90	38
CAP821	3,90	38
CAP880T	4,00	38
CAP881T/SS	3,90	38
CAP882T	5,00	38

### Bore and keyway tolerances

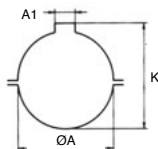

Bore and keyway

ØA	A1	K
25	8	28,3
30	8	33,3
35	10	38,3
40	12	43,3
45	14	48,8
50	14	53,8

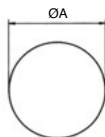

Smooth bore

ØA
25
30
35
40
45
50